

UPTOWN

LUXURY ELECTRIC FIREPLACES



UE43H

HOLOGRAPHIC FIREPLACE

AN ELECTRIC FIREPLACE HAS NEVER BEEN THIS REAL.

Uptown Luxury Electric Fireplaces has re-imagined what's possible with electric and holographic design, delivering a statement piece that stands apart. Built and engineered in North America, the UE43H brings the presence and sophistication of our luxury fireplaces into a new realm—fusing advanced holographic flame technology with refined architectural form. Innovative, elegant, and unlike anything else in its category, the UE43H sets a new standard for what a modern electric fireplace can be.

FIREPLACE FEATURES

45° Holographic
Reflective Glass

Ultra HD Flames

Ceramic
Fluted Liner

Adjustable
Top Light

Adjustable LED
Ember Bed

Real Wood
Charcoal

Run Quiet
Fan System

High Contrast
HD Screen



See the
UE43H
in action



<https://tinyurl.com/4ujebknb>

Burner Styles Options



Subtle Flame



Medium Flame



Large Flame



Nature Scene

Specifications

Heater	750 watt		
Fan	Run-Quiet Fan System		
Visible Dimensions	HEIGHT	WIDTH	
	17¾"	43"	
Install Dimensions	HEIGHT	WIDTH	DEPTH
	26"	43"	21⅝"

Please see owners manual for most up to date specifications.

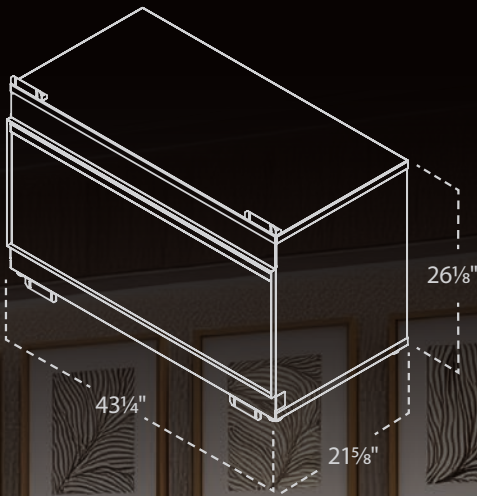

* Optional Steel Surround

UPTOWN
LUXURY ELECTRIC FIREPLACES



Manufactured by Sherwood Industries Ltd. | uptownfireplaces.com
Victoria, British Columbia, Canada | August 2025