



ERGOFOCUS HOLOGRAPHIK

Installation and operation
manual



CE

Table of contents

Introduction

Introduction	02
Warning	03
■ IMPORTANT SAFETY REGULATIONS	03
■ TO REDUCE THE RISK OF FIRE, ELECTRIC SHOCKS OR SERIOUS INJURY	03
Technical Specifications	04
■ EXPLODED VIEW	04
■ DIMENSIONAL DRAWING	05
Installation instructions	06
■ UNPACKING AND INSTALLING	06
Operating instructions	13
■ INSTRUCTIONS FOR USE	13
Maintenance	14
■ MAINTENANCE INSTRUCTIONS	14
Guarantee	14
Recycling	15
Appendix	16
■ COMPLIANCE STATEMENT	16

IMPORTANT

Read these instructions carefully before installing or using this appliance, and ensure that the customer keeps a copy in a safe place for future reference.

Introductory notes, please read before installing.

This appliance must be installed compliant to all applicable regulations concerning the safety of decorative installations and their use as well as this instruction manual and any relevant locally or nationally applicable building regulations.

Please read these instructions in full before installing.

This appliance must be installed compliant to all applicable regulations.

This manual concerns the following appliance:

· Ergofocus Holographik

Warnings

■ IMPORTANT SAFETY REGULATIONS

▲ WARNING

To avoid the risk of electrocution, always disconnect the power supply before handling. Contains no user serviceable parts. In the event of malfunction, contact the supplier.

■ TO REDUCE THE RISK OF FIRE, ELECTRIC SHOCK OR SERIOUS INJURY:

This appliance must be connected to an electrical power supply that complies fully with the power specifications indicated on its identification plate.

This appliance must be connected to an earthed power supply.

If an extension lead is required this must also have an earth connection.

Switch off the power supply at the associated circuit breaker to disconnect the appliance from the mains supply.

Power cables must be laid such that they are neither trampled over nor crushed by objects placed on or against them.

For safety reasons, if the appliance's power cable is damaged it must be replaced by the manufacturer, their after-sales service or a suitably qualified technician.

The appliance must not be exposed to water droplets or splashes, damp or other liquids.

Do not locate the appliance near to water; such as in a bathroom or near to a sink.

Never touch the power cable with wet hands, this could cause a short circuit and/or result in an electric shock.

To avoid any fire risk, never place a potential source of naked flames (matches, lit candles or a source of direct heat like a radiator, etc.) near to or on the appliance.

The appliance is designed exclusively for use in a temperate climate.

If the appliance emits smoke, an unusual odour or a strange noise: Switch off the power at the power breaker. Do not try to make repairs yourself, this could be dangerous.

Do not try to open or dismantle the appliance. Danger: high voltage.

Never try to insert any kind of object into the appliance through one of its openings, it may touch one or more of the electrical components which could result in an electric shock or a fire risk.

In the event of an electrical storm or lightning, switch off the power at the power breaker.

Do not use liquid or spray-on cleaners. Use a soft, dry cloth for cleaning.

Do not subject the product to sudden shocks, extreme temperatures or direct sunlight for long periods of time.

Keep the product away from magnetic objects, motors or power transformers.

Do not use outdoors, whatever the weather conditions.

Technical Specifications

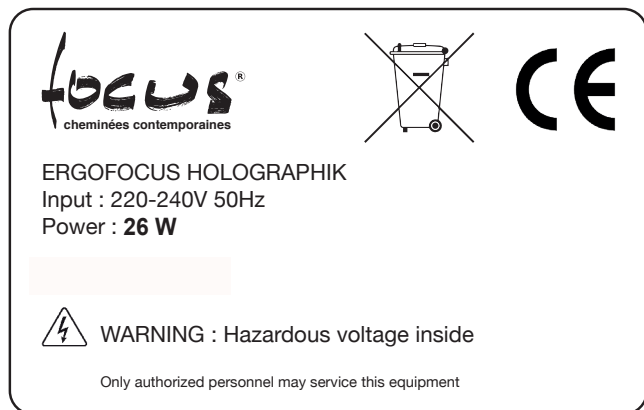

■ EXPLODED VIEW



Technical Specifications

■ DIMENSIONAL DRAWING

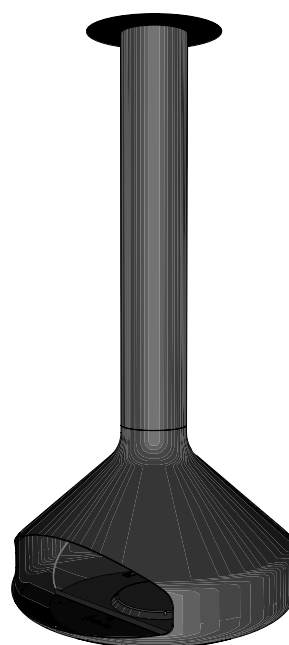
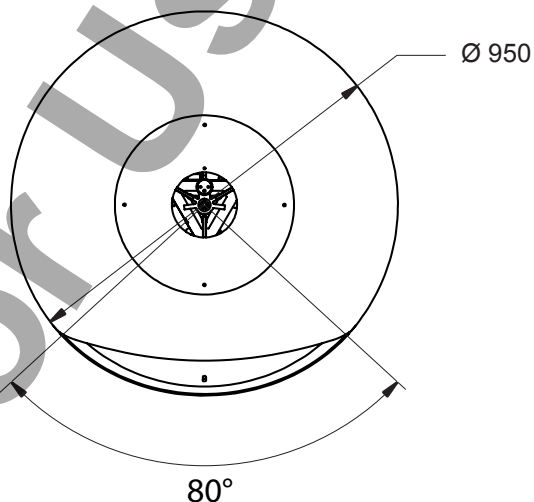
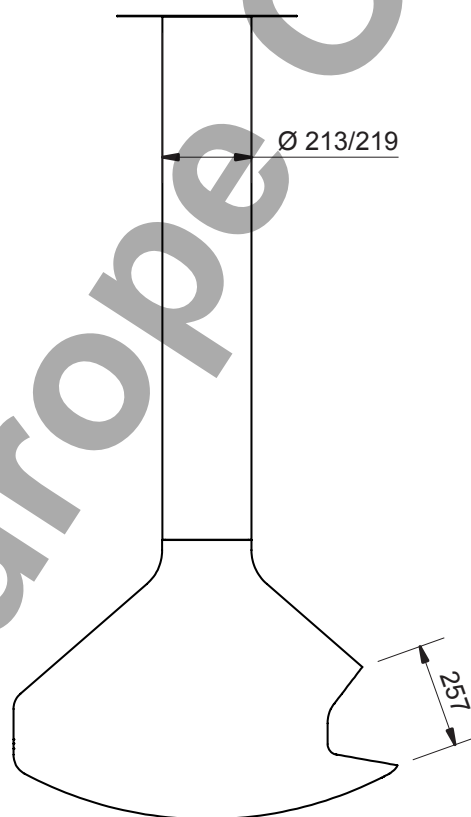
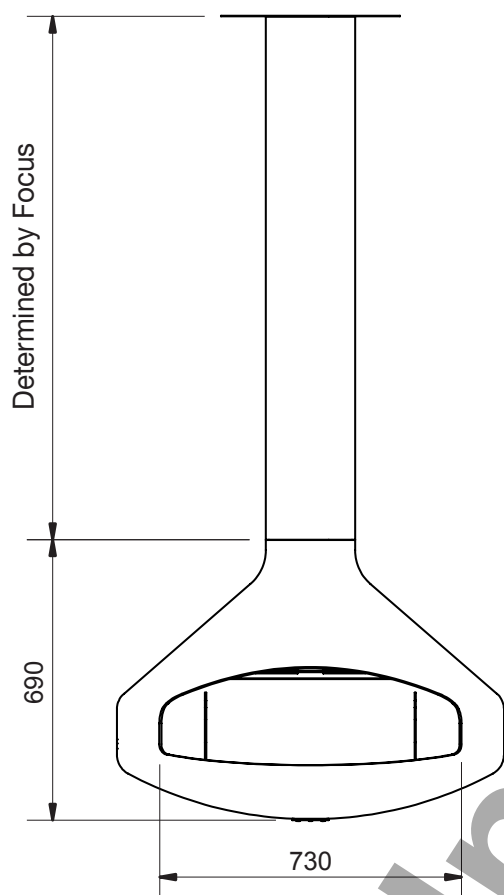

Installation instructions

■ GENERAL INFORMATION

To avoid damaging the fireplace, it should be unpacked and handled by two people.

Package contents:

- The appliance
- Screen
- Remote control unit
- Holographic glass screen
- Rotation limiter
- Rotation stop
- Cable tie
- Instructions

Read the instructions in full before installing and/or operating the appliance. Keep them safe for future reference.

Only install and operate the unit as shown in the instructions.

Please note that these instructions may not cover all possible situations. Be careful and use your common sense when installing, operating and maintaining the unit.

Never alter the unit's specifications in any way and never remove any of its fixed parts.

Ensure that the appliance is in good condition. Do not use the appliance if it is damaged, in this case contact the supplier or a qualified professional.

Packaging materials are recyclable. They should therefore be disposed off accordingly.

■ ELECTRICAL CONNECTION

Ensure that the power supply cable is disconnected from the mains supply during the installation process.

The appliance should be installed by a qualified professional.



The appliance must be connected to the power in accordance to professional practices and compliant to all applicable national standards for electrical installations (NF C15-100). Ensure that it is disconnected from the mains power and that the general mains switch for the installation is set to "O" before installing the unit. For safety reasons, if the power cable is damaged it must be replaced by the manufacturer, their after-sales service or a suitably qualified technician.

The appliance's required power supply voltage is 230 V ~ 50 Hz. Ensure that the power supply conforms to the appliance's power rating. Ensure that the power supply is fitted with a circuit breaker which will isolate the unit from the mains supply in compliance to all currently applicable regulations. The power supply must be fitted with a 10mA residual current circuit breaker (RCCB).

Installation instructions

■ INSTALLATION

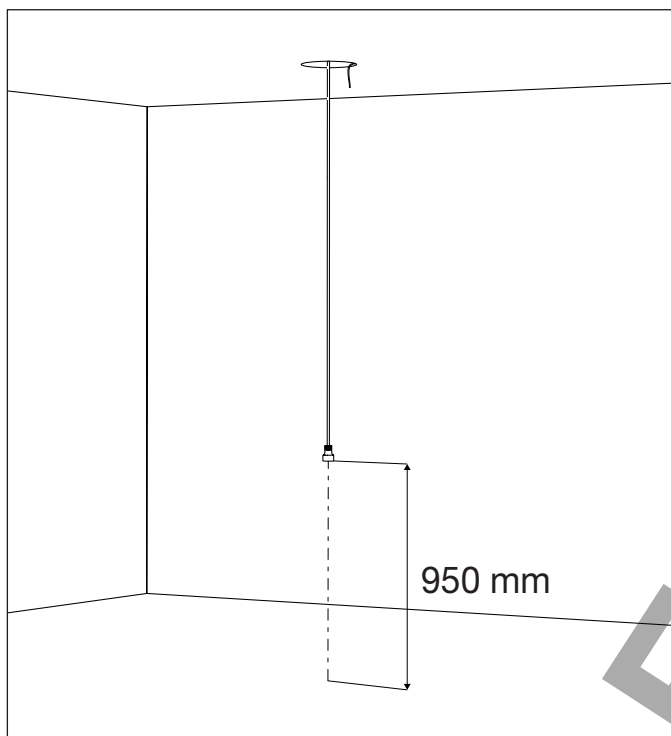

Fit a power supply cable with a female earthed connector at the end.

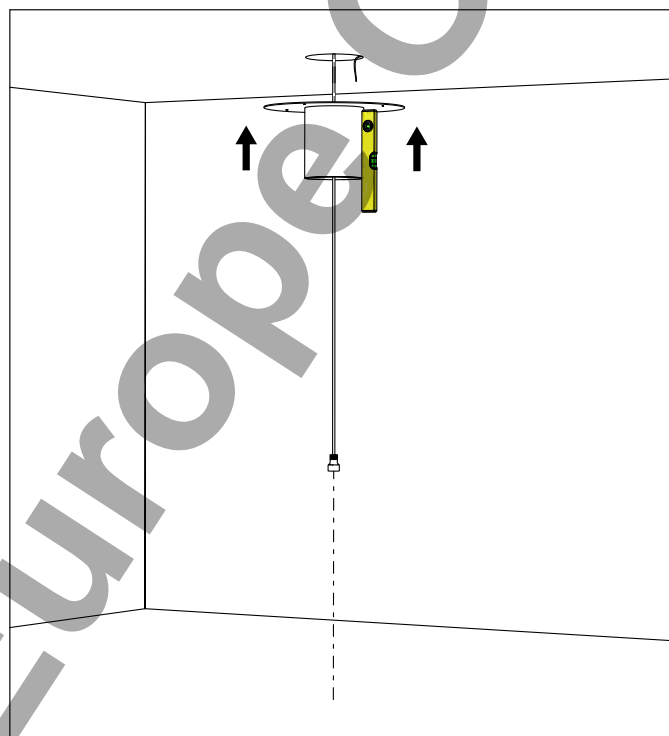

Fit the plate such that it is perfectly level.

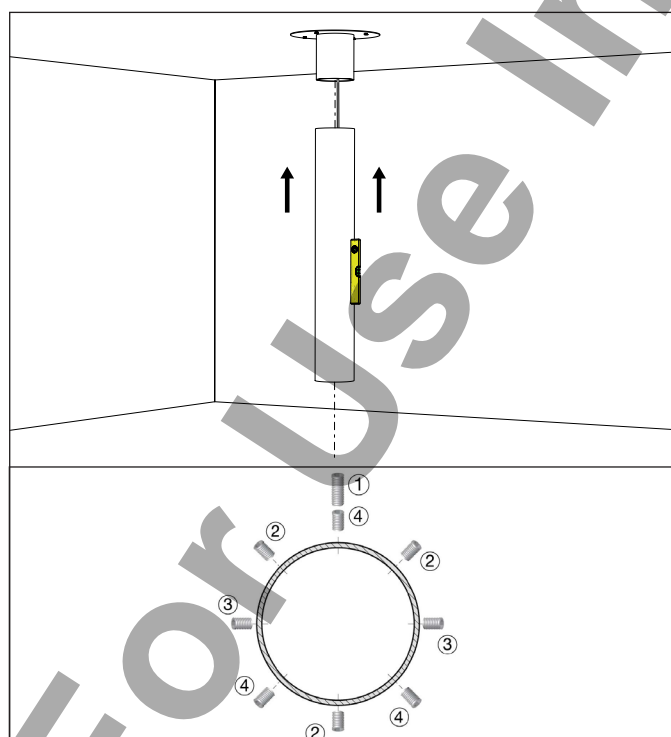

Attach the duct(s) following the tightening order shown

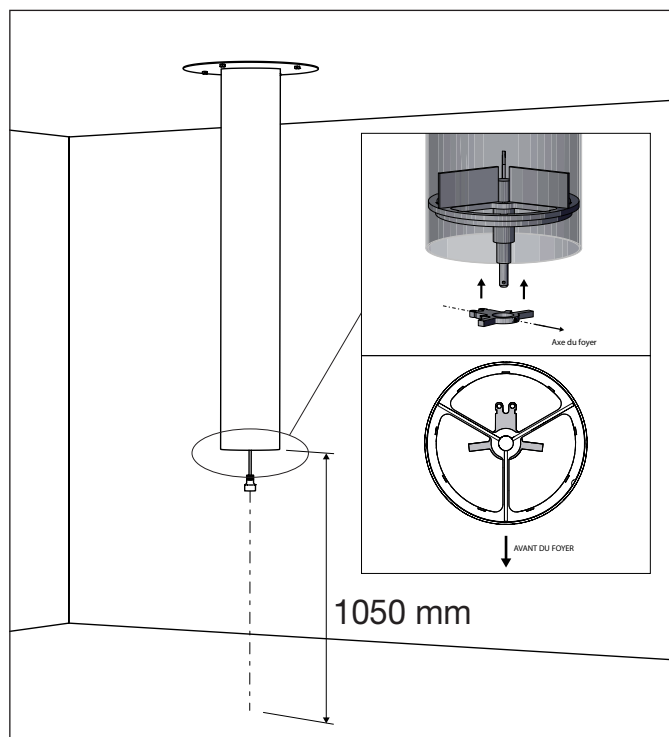

Fit the rotation limiter onto the axis of the duct, as shown above, respecting the given height as shown.

Installation instructions

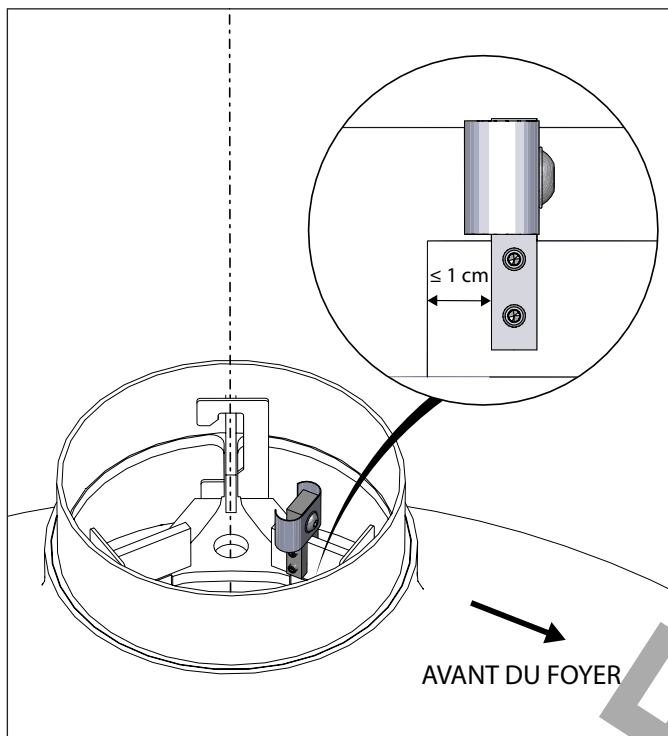

Fit the rotation stop over the cross on the front of the hearth.

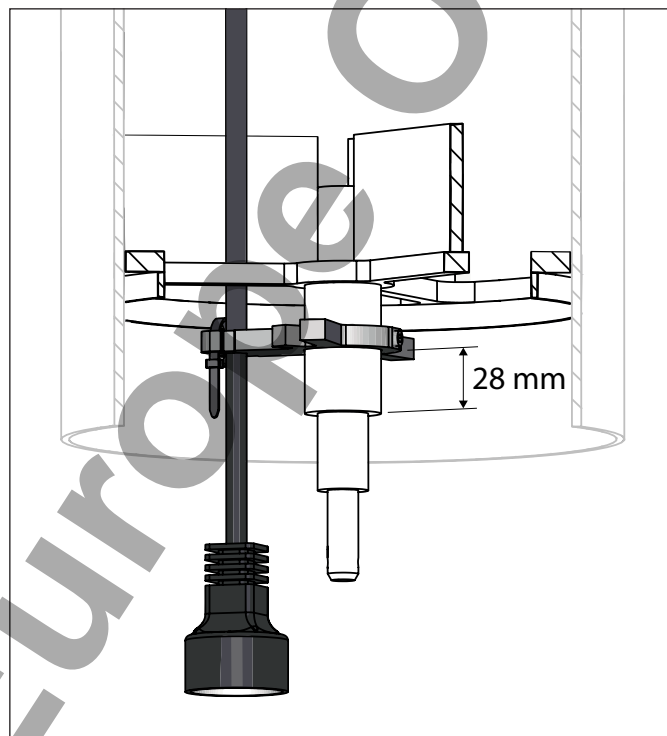

Place the power supply cable inside the limiter using the supplied cable tie.

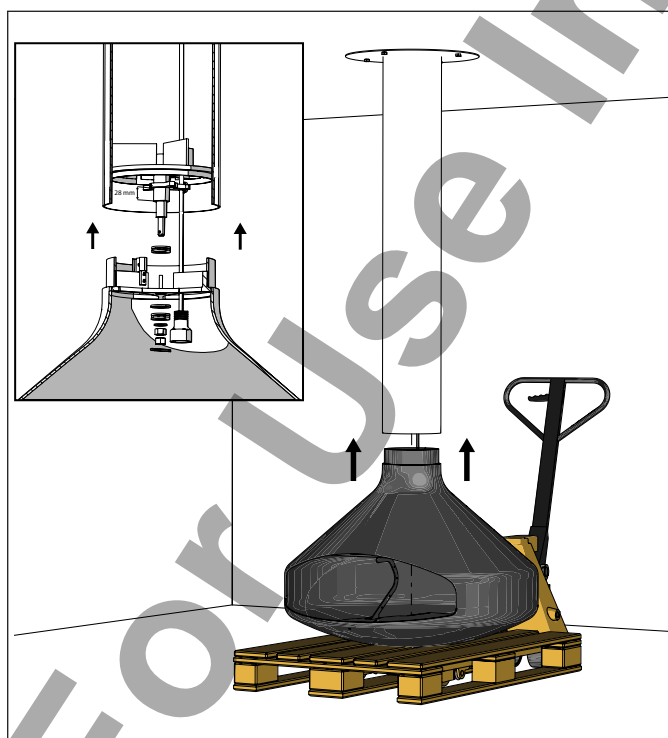

Connect the power supply cable and install the fireplace.

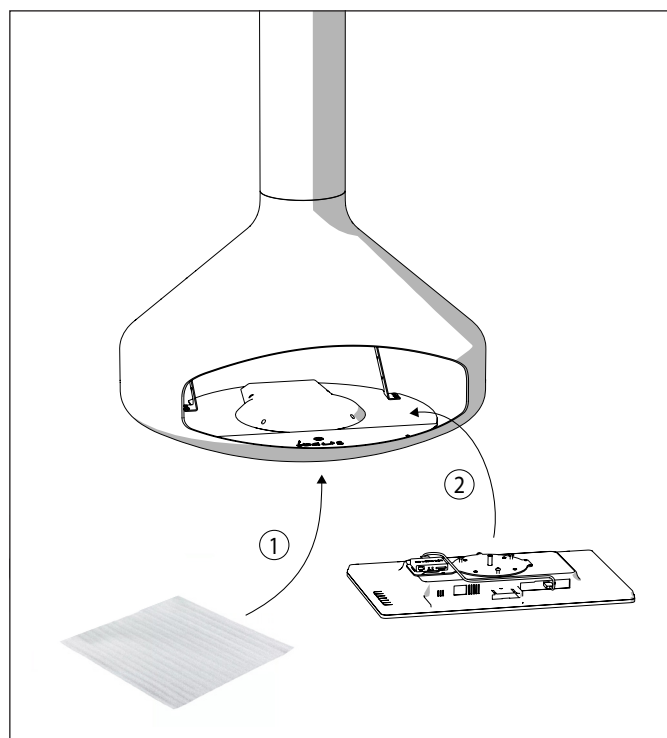

Fit the screen inside the fireplace.
Warning! To avoid damaging the screen, place a protective layer between it and the fireplace.

Installation instructions

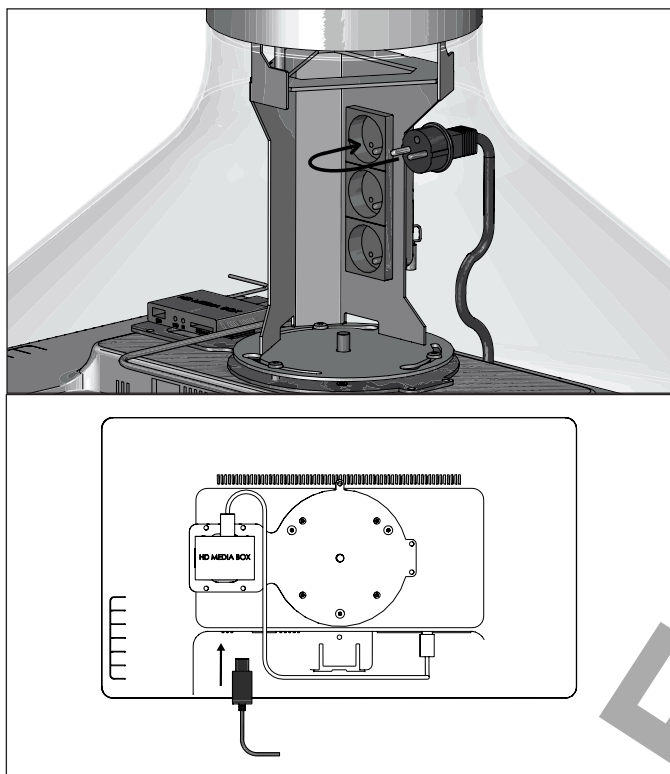

Connect the screen power supply cable.

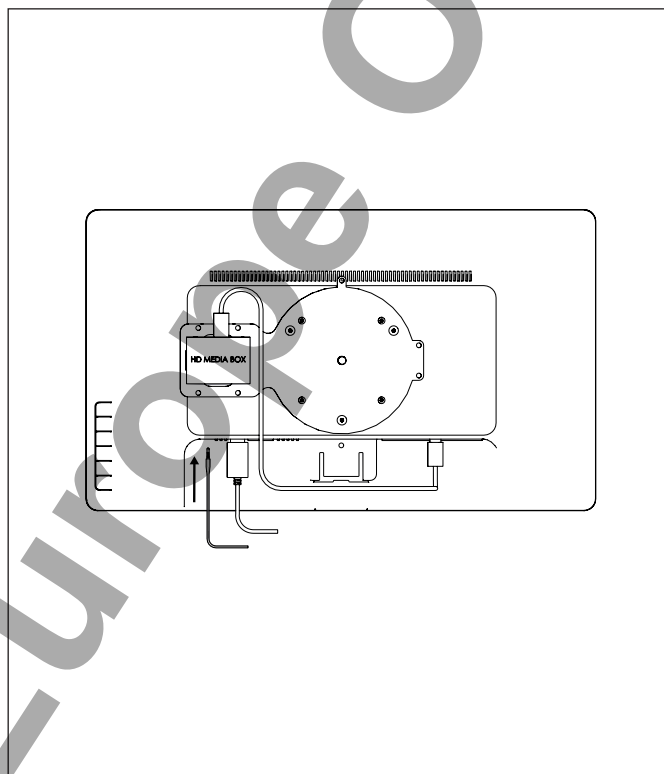

Connect the Jack cable to the screen.

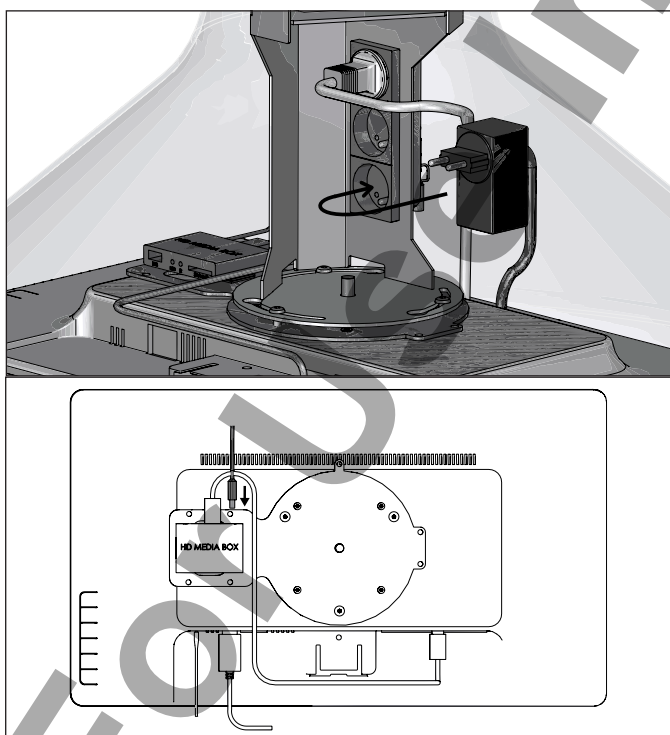

Connect the Player power supply cable.

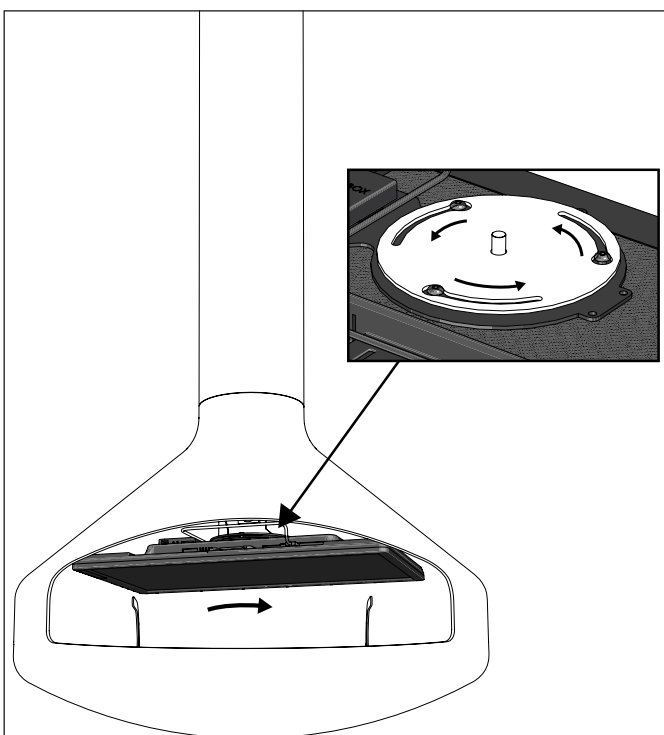

Install the screen by inserting the screws via the dedicated slots.

Installation instructions

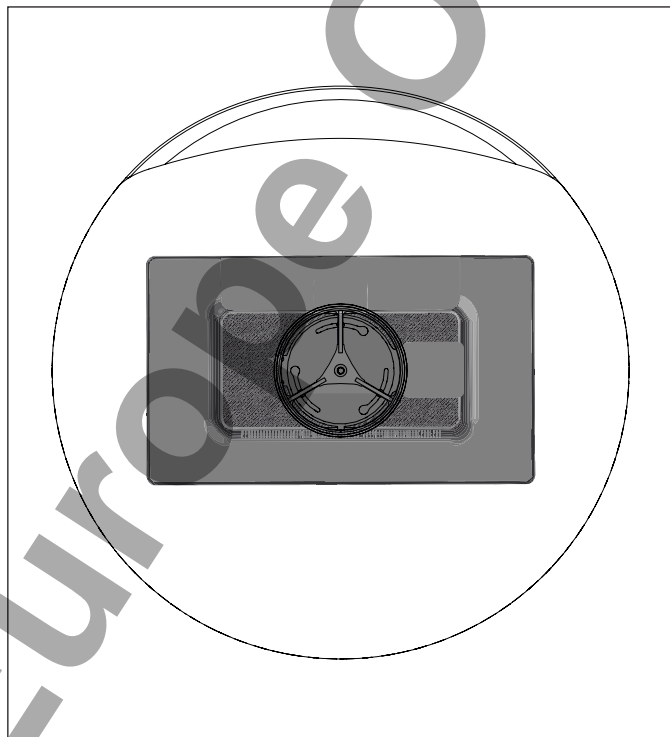
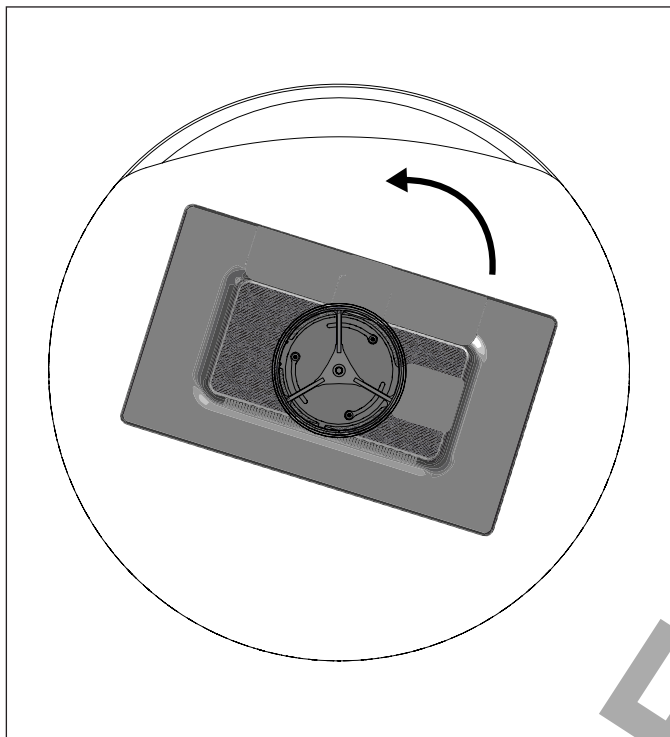

Adjust the screen such that it is parallel to the hearth opening.

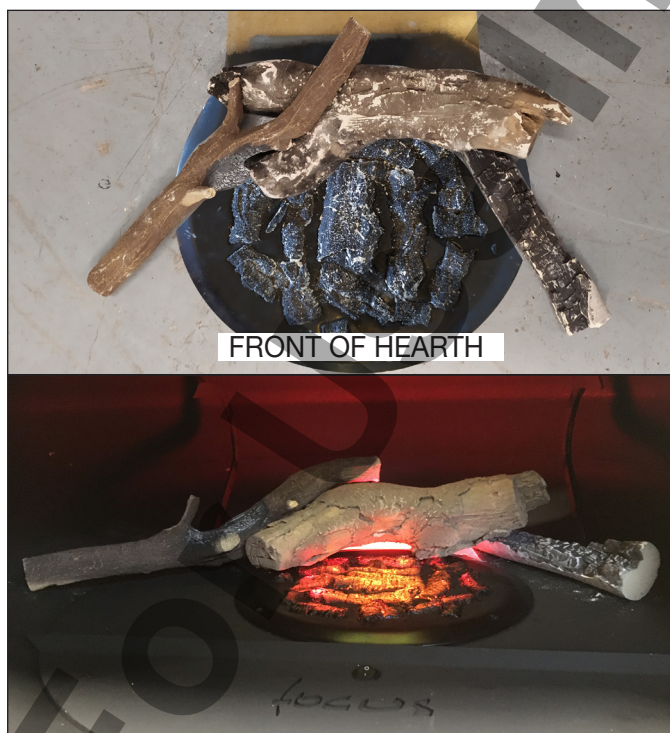

Place the logs as shown in the following steps.

Installation instructions



Place the ceramic logs as shown.

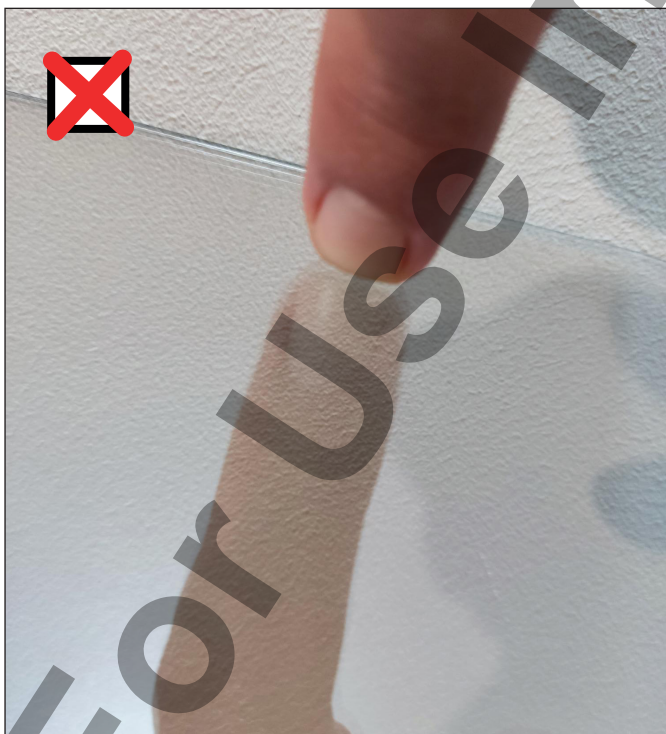

Identify the 'mirror finish' side of the glass sheet.

Installation instructions



Install the glass sheet with the “mirror finish” facing upwards.



Place the base of the glass sheet against its support.

Operating instructions

■ INSTRUCTIONS FOR USE



Set the O/I button to I to switch on.

Set the O/I button to O to switch off.

Volume control: hold the remote control as shown in the photo and press the "Vol + " button to increase the volume or the "Vol - " button to lower the volume.



■ MAINTENANCE INSTRUCTIONS

Always press the On/Off button before undertaking any maintenance operations.

Clean the screen and the glass sheet with a soft dry cloth.

If the surface is very dirty, wipe with a slightly damp soft cloth. Then wipe again with a soft, dry cloth.

Never use alcohol, benzene, solvent or any other chemical product. Do not use compressed air to remove dust.

The paintwork of the item may require retouching during its operational life. In this case, only use the Focus brand spray paint provided with the unit.

ASSEMBLY	REFERENCE
HDMI Cable	HOLOHDMI
Full HD Player	HOLOPLAY
Screen	HOLOECRAN
Base-plate + Electronic card assembly	HOLOESC
Glass screen	VERREERGOH

The guarantee does not cover parts subject to wear, nor does it cover issues or damages resulting from:

- (1) superficial wear from the normal operation of the unit;
 - (2) damage or wear from contact with food or liquids, or corrosion caused by rust;
 - (3) any unauthorised incident, mishandling, misuse, modification, dismantling or repair;
 - (4) any improper maintenance operation, usage non-compliant to the product instructions or connection to a power supply rating other than that specified;
 - (5) any use of accessories not supplied or authorised by FOCUS CREATION.
- This guarantee will instantly be considered null and void in the absence of the identification plate and/or product serial number.

Recycling

The presence of this logo on the product indicates that it is an appliance which should be disposed of compliant to the 2012/19/UE European directive concerning Waste Electrical and Electronic Equipment (WEEE), which states that used household appliances must be collected separately from household waste such that their different components can be recovered and recycled more effectively, thus reducing the environmental and human health impact of their disposal. Consequently, when this appliance reaches the end of its operational life it must not be disposed of with unsorted domestic waste. It must be disposed of through the the recovery and collection channels of local council waste disposal services or by the retailers.



DECLARATION OF CONFORMITY

ATELIER DOMINIQUE IMBERT s.a.s.
3 Impasse Claque Patin
F - 34380 Viols le Fort

declares that the Ergofocus Holographik complies with the following directives:

- 2014/35/CE (DBT)
- 2014/30/CE (CEM)
- 2011/65/CE (RoHS)

And with the essential requirements applicable to:

- EN 62368-1 :2014
- EN 55032 :2015
- EN 55035 :2017
- EN 61000-3-2 :2014 et EN 61000-3-3 :2013
- EN 62311 :2008
- EN 62321

Signed for and behalf of the manufacturer by:



Laurent Gaborit
Directeur Général

Viols le Fort, the 20 of September 2021

[illegible]

This image shows a full-page view of a document template. It features a light gray header at the top left containing the word "Notes". The main body of the page is white with horizontal dotted lines for writing. A large, semi-transparent watermark with the text "For Use In Europe Only" is oriented diagonally from the bottom-left towards the top-right.

[illegible]



Design - Publication - Distribution:
Atelier dominique imbert

S.A.S. (Simplified Corporation) with a capital value of 102,355 Euro
34380 Viols-le-Fort
France

Tel.: 00 33 (0)4 67 55 01 93
Web-site: www.focus-creation.com
Email: info@focus-creation.com