



## INSTALLATION AND OPERATIONS GUIDE FOR

### GRAND CANYON GAS JUMBO/JUMBO SLIMLINE LOG SYSTEMS

#### **Burner Systems:**

JUMBOSLIMBRNR-24

JUMBOSLIMBRNR-30

JUMBOBRNR-36 / JUMBOSLIMBRNR-36

JUMBOBRNR-42 / JUMBOSLIMBRNR-42

JUMBOBRNR-48 / JUMBOSLIMBRNR-48

JUMBOBRNR-60 / JUMBOSLIMBRNR-60

**Installation and service must be provided by a qualified installer, service agency or gas supplier**

Grand Canyon Gas Logs, logs are made of cement refractory material re-enforced with steel fibers. Each of the logs are hand painted and hand finished to recreate the most realistic logs available on the market. The gas burner system is designed to recreate and burn like a real wood burning fireplace with a natural looking flame. With this in mind the gas log sets **MUST** be burned in a fully vented, non-combustible fireplace with the **DAMPER COMPLETELY OPEN** and the chimney free of any obstruction or restrictions. The fireplace must be designed and approved to bur wood.

The realistic flame produced by Grand Canyon Gas Log burners produce carbon monoxide and soot. Under standard conditions these byproducts are exhausted up the chimney. **IF** the fumes or soot from the burning gas are evident in the room when the damper is fully open it indicates that the fireplace draft is defective. **IF** this happens **DO NOT** operate your gas logs until the fireplace drat is corrected, call a service technician to fix the problem.

**WARNING: If the information in this manual is not followed exactly, a fire or explosion may result, causing property damage, personal injury or loss of life**

- **Do not store or use gasoline or other flammable vapors and liquids in the vicinity of this or any application**

#### **WHAT TO DO IF YOU SMELL GAS**

- **Do not try to light any appliance**
- **Do not touch any electrical switch; do not use any phone in the building**
- **Immediately call the gas supplier from a neighbor's phone. Follow the gas supplier's instructions**
- **If you cannot reach the gas supplier, call the fire department.**
- **Installation and service must be performed by a qualified installer, service agency or the gas supplier**

Grand Canyon Gas Log sets are to be installed only in a solid-fuel burning fireplace with working flue and construction of noncombustible material. The installation including provisions for combustion and ventilation air must conform with the *National Fuel Gas Code*, ANSI Z223.1/NFPA 54, or the CSA B149.1 Natural Gas and Propane Installation Code, and applicable local building codes.

A damper clamp is included to maintain the minimum permanent vent opening and to prevent full closure of the damper blade. The chimney damper must be fully opened when burning the log set. The log set is designed to burn with a yellow flame, thus adequate ventilation is absolutely necessary.

To comply with certifications, listings, and building code acceptances, and for safe operation and proper performance of this log set, use only Grand Canyon Gas Logs parts and accessories. Use of other controls, parts, and accessories that are not designed for use with Grand Canyon Gas Logs log set is prohibited and will void all the warranties, certifications, listings and building code approvals, and may cause property damage, personal injury or loss of life.

#### **WARRANTY**

Grand Canyon Gas Logs burners and logs carry a lifetime warranty against breakage and defects to the original purchaser. ALL GCGL valves, pilot assemblies and electrical components carry a 2-year warranty as long as installed indoors and installed by a licensed professional. Further warranty information can be found in the warranty section of this guide.

**INSTALLER:** Leave this manual with the log set  
**CONSUMER:** Retain this manual for future reference.

## JUMBO / JUMBO SLIMLINE BURNER SPECIFICATIONS

PART #	DESCRIPTION	ITEM WEIGHT	BTU/HR RATING
JUMBOSLIMBRNR-24 /-SS	24" Jumbo Slimline / Stainless Steel Burner	55.00	75K-NG / 70K-LP
JUMBOSLIMBRNR-30 /-SS	30" Jumbo Slimline / Stainless Steel Burner	65.00	110K-NG / 105K-LP
JUMBOSLIMBRNR-36 /-SS	36" Jumbo Slimline / Stainless Steel Burner	75.00	150K-NG / 145K-LP
JUMBOSLIMBRNR-42 /-SS	42" Jumbo Slimline / Stainless Steel Burner	90.00	165K-NG / 160K-LP
JUMBOSLIMBRNR-48 /-SS	48" Jumbo Slimline / Stainless Steel Burner	110.00	195K-NG / 190K-LP
JUMBOSLIMBRNR-60 /-SS	60" Jumbo Slimline / Stainless Steel Burner	140.00	230K-NG / 225K-LP
JUMBOSLIMAWO24LOGS	24" Jumbo Slimline Arizona Weathered Oak Log set	112.0	
JUMBOSLIMAWO30LOGS	30" Jumbo Slimline Arizona Weathered Oak Log set	147.0	
JUMBOSLIMAWO36LOGS	36" Jumbo Slimline Arizona Weathered Oak Log set	188.0	
JUMBOSLIMAWO42LOGS	42" Jumbo Slimline Arizona Weathered Oak Log set	238.0	
JUMBOSLIMAWO48LOGS	48" Jumbo Slimline Arizona Weathered Oak Log set	271.0	
JUMBOSLIMAWO60LOGS	60" Jumbo Slimline Arizona Weathered Oak Log set	309.0	
JUMBOBRNR-36 /-SS	36" Jumbo / Stainless Steel Burner	75.00	150K-NG / 145K-LP
JUMBOBRNR-42 /-SS	42" Jumbo / Stainless Steel Burner	90.00	165K-NG / 160K-LP
JUMBOBRNR-48 /-SS	48" Jumbo / Stainless Steel Burner	110.00	195K-NG / 190K-LP
JUMBOBRNR-60 /-SS	60" Jumbo / Stainless Steel Burner	140.00	230K-NG / 225K-LP
JUMBOAWO24LOGS	24" Jumbo Arizona Weathered Oak Log set	118.0	
JUMBOAWO30LOGS	30" Jumbo Arizona Weathered Oak Log set	157.0	
JUMBOAWO36LOGS	36" Jumbo Arizona Weathered Oak Log set	198.0	
JUMBOAWO42LOGS	42" Jumbo Arizona Weathered Oak Log set	250.0	
JUMBOAWO48LOGS	48" Jumbo Arizona Weathered Oak Log set	287.0	
JUMBOAWO60LOGS	60" Jumbo Arizona Weathered Oak Log set	315.0	

### FIREPLACE SIZE REQUIREMENTS FRONT VIEW

Burner Size	Min. Fireplace Dimensions				Height	BTU	
	Width		Depth			NAT.	L.P.
	Front	Rear	Jumbo	Slimline			
24"	36"	24"	-	21"	24"	75K	70K
30"	42"	30"	-	21"	24"	110K	105K
36"	48"	36"	23"	21"	24"	150K	145K
42"	54"	42"	23"	21"	24"	165K	160K
48"	60"	48"	23"	21"	24"	195K	190K
60"	72"	60"	23"	21"	24"	230K	225K

## IMPORTANT INFORMATION

**WARNING: This appliance assembly contains burner orifices specifically for the input gas specified on the burner and box, as well as the Btu rating specified in this manual. Modifying or failure to use the factory orifice may cause property damage, personal injury or loss of life.**

**Read these instructions completely before installing and using Grand Canyon Gas Logs system.**

1. Gas type will be indicated on the burner and the box. Do not use a natural gas burner with propane or a propane burner with natural gas.
2. The installation, provisions for combustion, and ventilation air must conform to the National Fuel Gas Code, *ANSI Z223.1/NFPA54*, or the *CSA B 149.1*, National Gas and Propane Installation Code.
3. For warranty to be valid gas log sets must be installed by a NFI certified or other qualified professional installer.
4. This appliance must be installed only in a solid-fuel burning fireplace with a working flue and constructed of non-combustible materials. Solid fuels are not to be burned in a fireplace where a decorative appliance has been installed.
5. A permanent free opening must be provided by either the fireplace chimney or chimney damper to vent carbon monoxide and other flue gases. Any chimney damper must be fixed in a manner, which will maintain the permanent free opening at all times. Use the table at the bottom of this page to determine the minimum permanent free opening based on chimney height and the appliance Btu rating.
6. A fireplace screen must be in place when the appliance is operating and, unless other provisions for combustion air are provided, the screen shall have an opening(s) for introduction of combustion air. With use of glass doors, doors must be open while the appliance is burning to assure proper ventilation.
7. The minimum inlet supply pressure for the purpose of input adjustment is 5.0 inches (natural gas) 8.0 inches (propane) in water column. The maximum inlet supply pressure is 10.5 inches (natural gas) 13.0 inches (propane) in water column.
8. The appliance and its individual shut-off valve must be disconnected from the gas supply piping system during any pressure testing of that system at test pressures in excess of ½ psig (3.5kPa). The appliance must be isolated from the gas supply piping system by closing its individual manual valve during pressure testing equal to or less than ½ psig (3.5kPa).
9. The appliance area is to be clear and free from combustible materials, gasoline and other flammable vapors and liquids.
10. Do not use this appliance if any part has been under water. Immediately call a qualified service technician to inspect the appliance and to replace any gas control which has been under water.

### IMPORTANT

**For all valves, the air MUST be purged from the gas line before the pilot will light and burn properly. The time needed to purge will depend on the length of the gas line to the unit and the amount of time since the unit or gas line was last used. It may take several minutes before all the air is purged and the pilot will light and burn properly. Follow the LIGHTING INSTRUCTIONS section in this manual.**

**MINIMUM CHIMNEY HEIGHT AND FLUE OPENING**

**For Factory Built Fireplaces Free Opening Area Of Chimney Damper For Venting Combustion Products From Decorative Appliances For Installation In Solid Fuel Burning Fireplaces**

Chimney Height* (ft)	Appliance Input Rate (kBTU/hr)											Max. Input***
	20	30	40	50	60	70	80	90	100	110	120	
	Minimum Opening** (sq. in.)											
10	11.3	16.6	22.1	28.3	35.3	44.2	—	—	—	—	—	77.6
15	8.6	12.6	17.3	21.2	26.4	32.2	38.5	45.4	—	—	—	98.2
20	7.5	10.8	14.5	18.1	22.1	26.4	31.2	37.4	43.0	—	—	114.2
25	6.6	9.6	12.6	15.9	18.1	22.9	27.3	31.2	36.3	43.0	50.3	121.0
30	6.2	9.1	11.3	14.5	17.3	20.4	24.6	28.3	33.2	37.4	44.2	130.1
35	5.7	8.0	10.8	13.2	15.9	18.9	22.1	25.5	30.2	34.2	39.6	141.2
40	5.3	7.5	10.2	12.6	15.2	18.1	20.4	23.8	27.3	31.2	35.3	158.5

\* Height is from hearth to top of chimney and the minimum height is 10 feet. (See Figure 3, Factory Built Fireplace.)

\*\* Chart shows minimum opening (sq. in.) for the given height and input rate.

\*\*\* Column marked "Max. Input" corresponds to the maximum allowable input rate (kBTU/hr) for the given height.

**For Masonry Built Fireplaces Free Opening Area Of Chimney Damper For Venting Combustion Products From Decorative Appliances For Installation In Solid Fuel Burning Fireplaces**

Chimney Height* (ft)	Appliance Input Rate (kBTU/hr)										
	20	30	40	50	60	70	80	90	100	110	120
	Minimum Opening** (sq. in.)										
6	17.6	25.7	33.8	41.7	49.2	56.6	64.0	71.4	78.8	86.2	93.5
8	16.5	23.7	31.2	38.7	45.5	52.4	59.7	66.9	74.1	81.3	88.6
10	15.1	21.7	28.7	35.2	41.7	48.2	54.3	60.2	66.1	72.0	77.9
15	14.1	19.9	26.1	32.0	37.7	43.2	48.8	54.1	59.4	64.6	69.9
20	12.9	18.5	23.7	28.8	34.3	39.8	44.4	49.1	53.8	58.4	63.0
30	12.2	16.9	21.6	26.5	31.2	35.9	40.3	44.5	48.6	52.7	56.6

\* Height is from hearth to top of chimney and the minimum height is 6 feet. (See Figure 3, Factory Built Fireplace.)

\*\* Chart shows minimum opening (sq. in.) for a given height and input rate.

## BOX CONTENTS

### BURNER KIT –

1. Slimline / Jumbo Burner
2. Lava Rock
3. Glowing Embers
4. Flex Line w/ Fitting
5. Damper Clamp

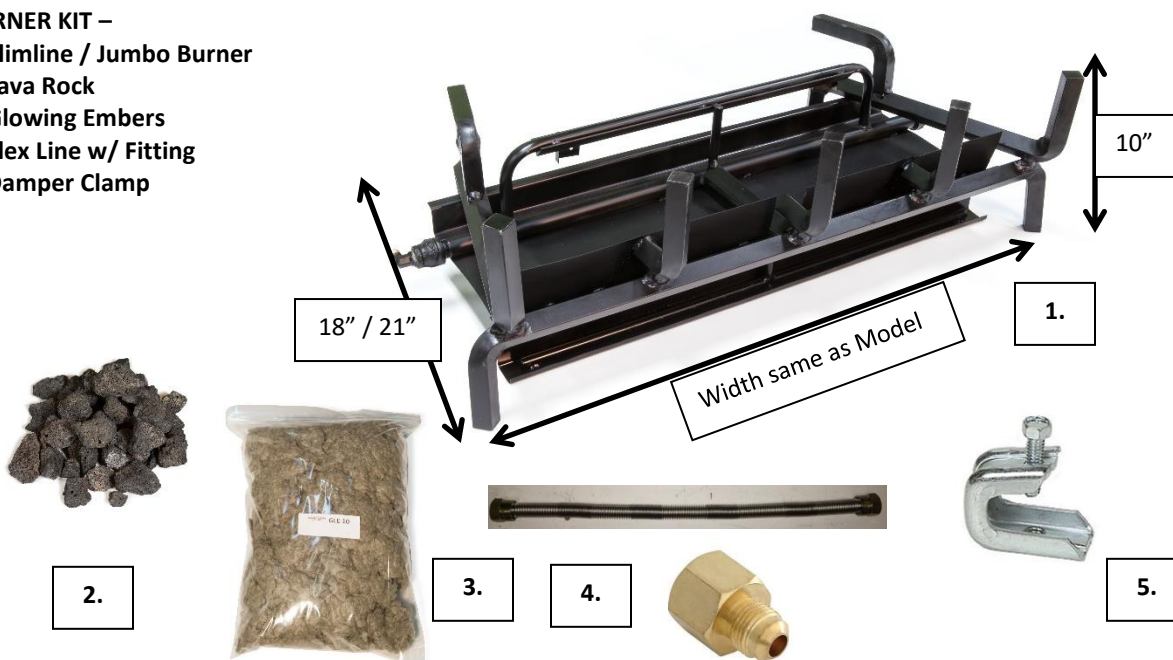

### LP Conversion Kit –

#### Installation:

1. Remove Merchant Coupling & 90° Elbow from the gas inlet side of the burner.
2. Drill Out the brass orifice/air mixer to the burner and LP orifice size listed below.
3. Using piping dope compound, replace the orifice / air mixer and fitting cap back on the burner.



<u>Size</u>	<u>WC. Pressure Minimum</u>	<u>BTU Rating</u>	<u>Orifice Size</u>
24"	11"	70K	38
30"	11"	105K	31
36"	11"	145K	27
42"	11"	160K	24
48"	11"	190K	19
60"	11"	225K	15

## INSTALLATION

The damper clamp with hex bolt is provided as a means to prevent full closure of the damper blade. The clamp can be attached to most damper blades with pliers or a wrench, and must be permanently installed. The clamp is designed to prevent accidental closure of the damper when installed. Should the clamp not fit or fail to provide the permanent vent opening listed in the table above, have a permanent stop installed, remove the damper blade or have the damper cut to provide the minimum permanent opening required.

### BURNER INSTALLATION:

Notes – With all ISOFLAMES Burners the gas can be installed on either the left or the right side of the burner, set up burners according to where the gas enters the fireplace.

1. Position the burner in the center of the fireplace with or without a valve system.
2. Connect whistle free flex to the burner/valve & the gas inlet.

### BURNER MEDIA INSTALLATION:

NG - Tear or Rip embers in pieces as small as possible. Use either a comb or brush to achieve this. The smaller the piece, the better the ember glow. Pour Vermiculite along the bottom ember bed. Spread the embers across the front burner, ember burner and fill up the pan. Dump lava rock around the burner coving the hearth.

LP - Tear or Rip embers in pieces as small as possible. Use either a comb or brush to achieve this. The smaller the piece, the better the ember glow. Pour Vermiculite along the bottom ember bed. Spread the embers across the front burner, ember burner and fill up the pan. Dump lava rock around the burner coving the hearth.



**VALVES PARTS LIST – IF PURCHASED**

**HIGH CAPACITY SAFETY PILOT**  
**HCSPK-LP / NG**



**HIGH CAPACITY MILLIVOLT**  
**HCMVQMKLP / NG w/GCRK**



**EIS / EIS-OUTDOOR**  
**EIS / -LP w/GCRK**  
**EIS-OUTDOOR / LP w/GCRK**

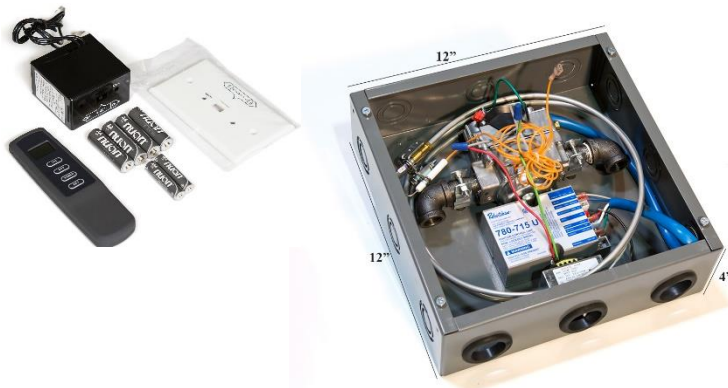

## LOG PLACEMENT GUIDE

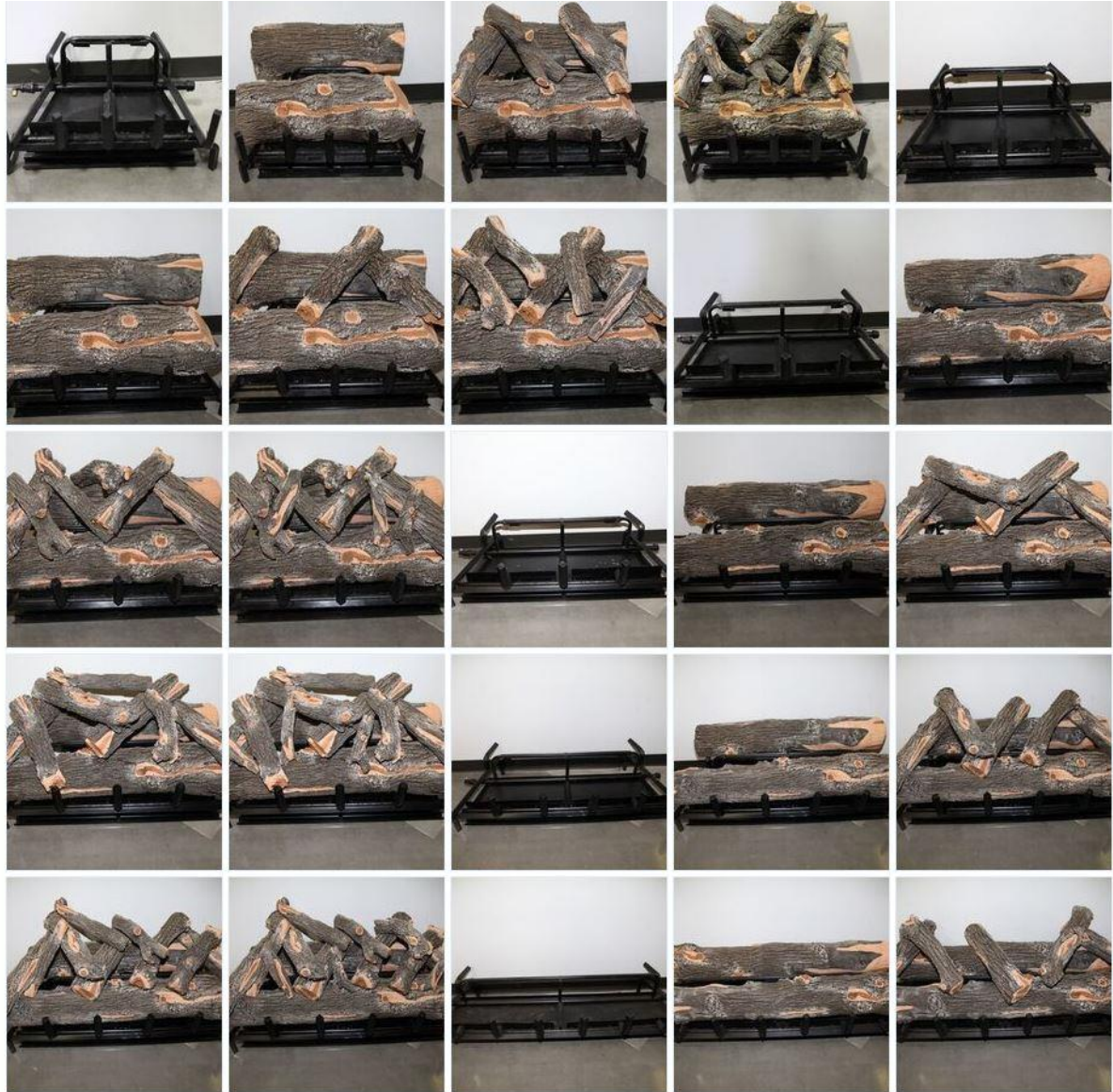



## WARRANTY

**Refractory Logs:** Grand Canyon Gas Logs, logs carry a lifetime warranty against any manufacture defects or breakage as long as the products are installed inside. In the event defect or breakage occurs a replacement will be available to pick-up from the dealer at which the log set was originally purchased. This warranty does not cover breakage caused by excessive handling once installed and fired. Logs installed outdoors carry a (5) year warranty. This warranty is limited to original purchaser only.

**Burner:** Grand Canyon Gas Logs burners carry a life time warranty against manufacturer defects or breakage as long as the appliance is installed inside and by a professional installer. In the event a defect or breakage occurs a replacement will be available for pick-up from the dealer at which the burner was originally purchased. Stainless Steel Burners installed outside carry a lifetime warranty against manufacturer defects or breakage. This warranty is limited to original purchaser only.

**Electrical and Valves:** Grand Canyon Gas Logs valves, pilot assemblies and electrical components carry a (2) year warranty against breakage or defects from date of purchase, by original purchaser, and must be installed be a licensed professional installer. This warranty only covers use with ISOFLAMES burners and logs In the event a defect or breakage occurs a replacement will be available for pick-up from the dealer at which the burner was originally purchased. Products installed outdoor carry a (1) year warranty.

### WARRANTY CARD:

Please fill this warrant card and mail it to Grand Canyon Gas Logs to receive a warranty claim

Purchased from:

City, State

Day/Month/Year:

Your information

Name:

City, State:

Phone Number:

Date of install:

Mail to:

EarthCore/ISOFLAMES c/o

3435 E. Atlanta Ave.

Phoenix, AZ 85040