

TOFINO z35

ZERO CLEARANCE GAS FIREPLACE

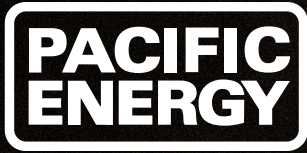

ELEGANT • VERSATILE • EFFICIENT



Safety is important and with today's advanced technologies and materials, there's no need to compromise aesthetics for safety. That is why Tofino Fireplaces come standard with an integrated micromesh screen that creates a virtually invisible safety barrier, allowing a clear, unobstructed view of the flame.

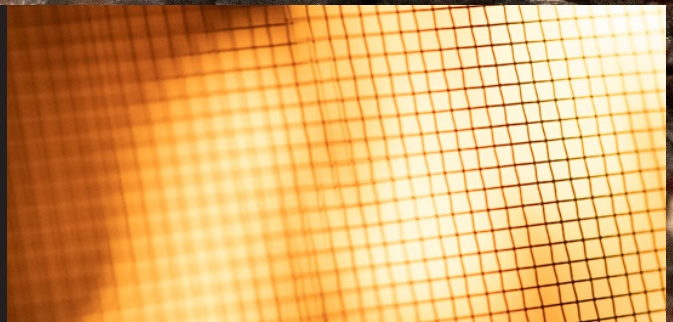

TOFINO SERIES

ELEGANT | VERSATILE | EFFICIENT

The Tofino Series of gas fireplaces offers you the highest level of quality, technical innovation, and performance for your home. Designed for new construction and renovation projects, the z35 provides maximum heat and ultimate energy efficiency with easy, one-touch programmable control. Heat output and flame heights are variable, allowing you complete control over comfort and appearance. Even at the lowest settings, the Tofino z35 flames are appealingly rich and full to gently warm your environment.

Transform your space with Pacific Energy's unique Design-A-Fire system of interchangeable interior options. Whether you choose a bed of fire over tumbled glass and lustrous porcelain enamel interior walls, or a rustic logset against a backdrop of stacked brick, your new gas fireplace offers expansive viewing area of the flame and the ability to create a fireplace that uniquely complements your style and your home.

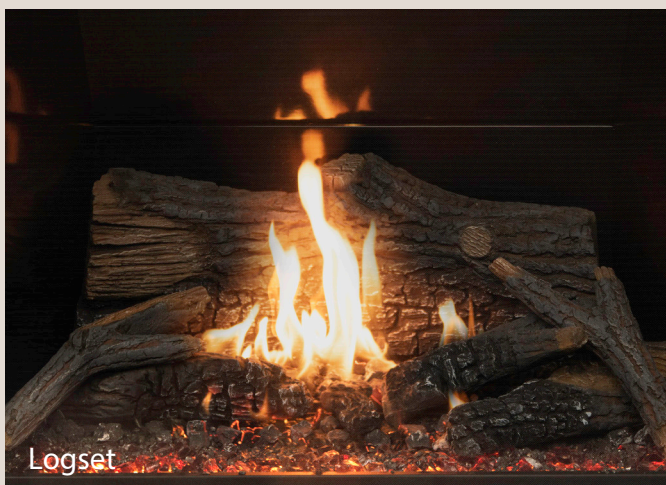

DESIGN-A-FIRE. UNLIMITED POSSIBILITIES.

Our selection of interchangeable interior elements that allows you to customize your fireplace. It's the freedom to create the perfect combination of color, finish, and detail for your home.

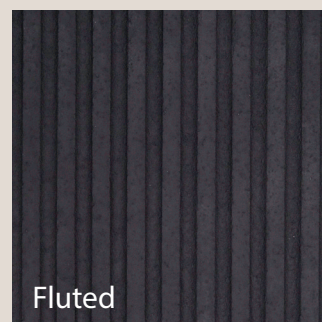
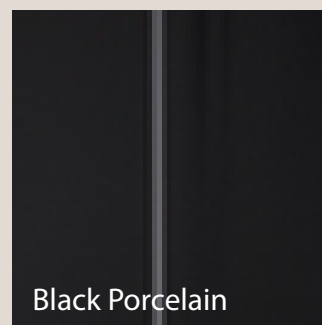



BTU INPUT

NG high 35,000 BTU/hr	P.4.1 72.1%
NG low 9,000 BTU/hr	
LP high 26,000 BTU/hr	P.4.1 70.9%
LP low 7,500 BTU/hr	

8 X 5 DIRECT VENT

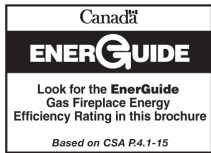

STANDARD FEATURES

- SIT Proflame 2 system
- Split flow valve
- Top interior lighting
- Ember bed lighting *
- Preinstalled burner tray
- Remote Control
- Wall switch
- Home automation
- Easy open door latch
- Up front venturi adjustment
- Up front flue damper adjustment
- Up front gas shut off
- Dedicated NG / LP units

* logset only

OPTIONS

- Glass or Logset Fire Media
- Two glass colours: Black and Twilight
- Four firebox panel designs: Black Porcelain, LedgeStone, Fluted, Red Brick
- Cool Wall Kit

Cool Wall Kit

The optional Pacific Energy cool wall system channels heat to create a cool space directly above your fireplace.

DIMENSIONS & CLEARANCES

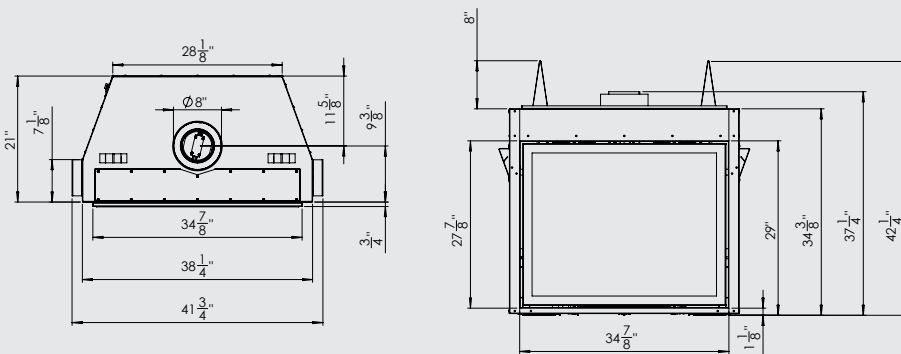

For reference only. Installations should be based on manuals and rating labels.

CLEARANCE TO COMBUSTIBLES

Venting clearance to combustibles	2 1/2"
Clearance above unit	8"
Center of the unit to a side wall	20"
Hearth in front of unit	0"
Side of unit in chase + back	1 3/4"

MANTEL CLEARANCE FROM FLOOR

Mantel Size	Standard Unit	With Cool Wall Kit
1"	36"	32"
6"	42"	32"
9"	48"	32"

Pacific Energy is committed to continuous product improvement and innovation. As a result, appearance and specifications of the products featured in this brochure are subject to change without notice.

For more information, please visit pacificenergy.net

SKU: 12900013 06/19 10M – Printed in Canada



pacificenergy.net