



# SKAMOTEC 225

## INSTALLERS GUIDE

For 1-1/2" Thickness

SKAMOTEC 225  
Installation Video



For more information contact:  
Toll free 1-(844)-475-2665  
[www.skamotec225.com](http://www.skamotec225.com)  
[skamotec225@skamol.com](mailto:skamotec225@skamol.com)



# SKAMOTEC 225 – The One Product Solution

Skamol introduces an innovative new method of building fireplace enclosures; **Skamotec 225** a non-combustible board that simplifies the construction process by eliminating the need for steel or wood frame construction.

## SKAMOTEC Advantage

- **ONE building material: No steel or wood framing**
  - Saving time, labour costs, and callbacks
- **Fire protection: non-combustible**
  - UL Classified: ASTM E136
  - UL Listed: CAN/ULC-S114
- **Excellent thermal protection**
  - R-value = 3.57
  - K-value = .28
- **Withstand temperatures up to 1832 °F**
- **Extremely lightweight**
  - 50% lighter than other non-combustible board
- **Quick and easy to install with common woodworking tools**
- **Easy application when applying finishing materials**
- **Non-toxic & land-fill friendly**

## Standard Sizes

Thickness	Width x Length	Weight
• 1-1/2"	48" x 80.31"	46.29 lb.

# Hardware Required

## Tools

Simple wood working tools and blades. No diamond blade needed.

Tip: cut Skamotec 225 on flat level surface and use straight edge when cutting for clean lines



## Fasteners

#8 x 2-½" Coarse Thread Construction Screws

- **Skamotec 225 to Skamotec 225**

#8 x 3" Coarse Thread Construction Screws

- **Skamotec 225 to studs, ceiling, drywall & flooring**

Note: Use a fastener spacing of 6" – 8" with an minimum edge distance of 3/4" – 1"

## Adhesive / Mortar (High temperature areas above 160°F)

Recommended mortar:

- High Temperature Mortar or Silicone rated above 600°F
  - Prepare the surface by moisten the surface with water

Note: For use when attaching

**Skamotec 225 to Skamotec 225** around fireplace opening

**Do NOT fasten Skamotec 225 to fireplace**

## Adhesive (Low temperature areas only)

Recommended construction adhesives:

- (US) Loctite - PL® Premium® 3X
- (Canada) LePage - PL® Premium® 3X
- Prepare the surface by moisten the surface with water

Note: For use when attaching

**Skamotec 225 to drywall**

**Skamotec 225 to flooring**

**Skamotec 225 to Skamotec225**



## Typical Construction Method

**Support blocking (Existing Wall Attachment)**  
Min. 1 ½" x Min. 1 ½"

**Joint plate (Vertical Panels)**  
4" wide (minimum)

**Support blocking (Corner Joint)**  
Min. 1 ½" x Min. 1 ½"

All the material you required to build your fireplace enclosure is constructed using **SKAMOTEC 225**

### Key Installation Points

- All corner & panel joints **must have** support blocking (Min. 1 ½" x Min. 1 ½") or joint plate (4" wide minimum)
- When connecting two (2) vertical panels, all joints must be supported with an additional joint plate on the backside with 4" minimum width.
- All corner & panel joints **shall be attached using** mortar cement or construction adhesive, and 2-1/2" screws
- When applying any adhesive, mortar cement, drywall compound, paint, skim-coat or a scratch coat all joining surfaces **must be moistened with water** beforehand. This will prevent these products from drying out too quickly & adhering incorrectly
- Always maintain a **minimum of 1/8" clearance** from all fireplace surfaces; this is to allow for expansion of the fireplace and to prevent cracking.
- Do **not** fasten any part of Skamotec 225 to the fireplace unit; this is to allow for expansion.

**Support blocking (Floor & Ceiling Attachment)**  
Min. 1 ½" x Min. 1 ½"

**Display showing typical building method**

Note:

Skamotec 225 building board is intended for interior, non-load bearing wall applications.

# Basic Assembly Instructions

## Step 1: Option 1

Install Support blocking to back wall and floor. Support blocking must tie into structure of the existing wall and floor. This may require support blocking to be larger than 1-½". Support blocking may be multiple pieces and used from scrap / off cuts

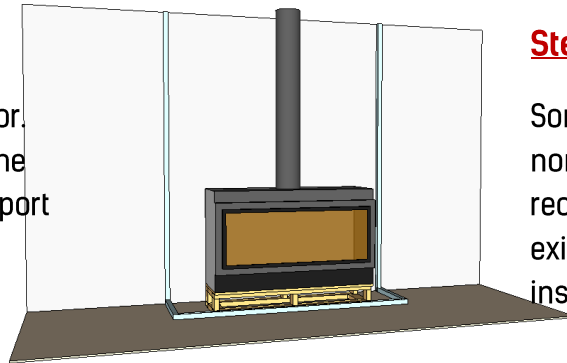

## Step 1: Option 2

Some units may require a complete non-combustible back wall. We recommend using full sheets on existing back wall. See fireplace installation manual for details.

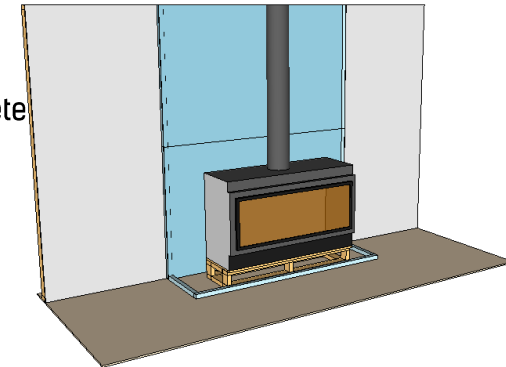

## Step 2:

Install side panels. We recommend pre-assembling panels. Support blocking must be in Corner Joint and 4" minimum Joint Plate used when joining two pieces.

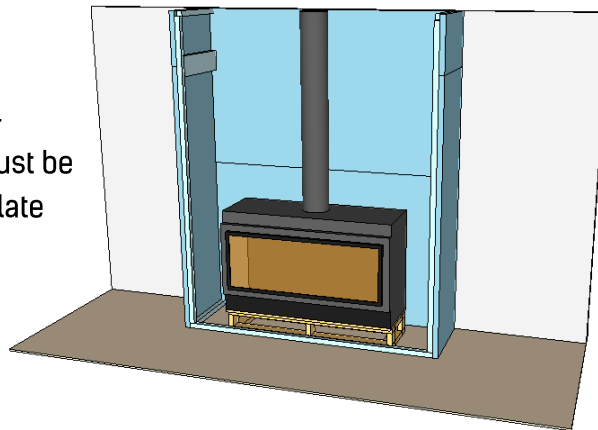

## Step 3:

Install front panel.

4" minimum Joint Plate must be used when joining two pieces.

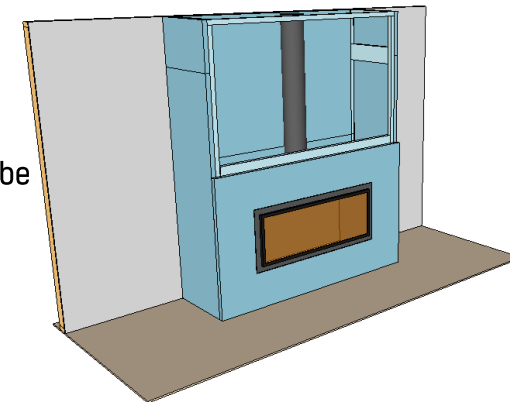

## Step 4:

Install top panel.

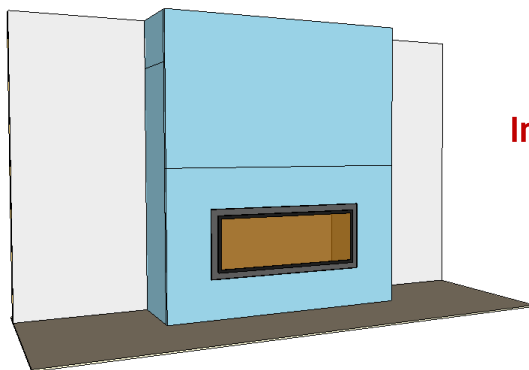

## Important

- All surface joints must be fastened using 2-1/2" screws & adhesive or mortar cement
- **Moisten all surfaces with water** before applying adhesive or mortar cement
- Use a fastener spacing of 6 – 8" with a minimum edge distance of 3 /4" – 1"

## Finishing Around the Fireplace Opening

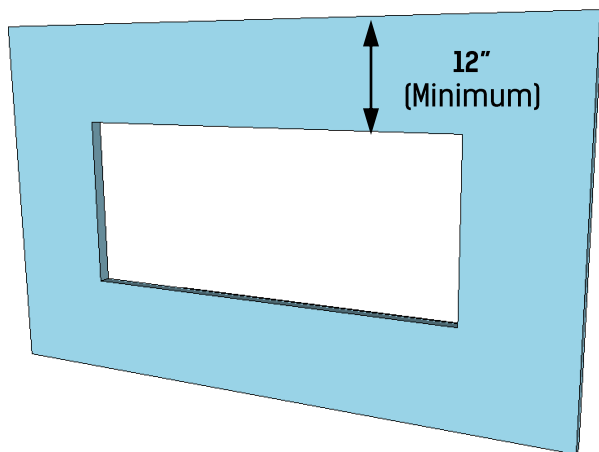

### Option #1

Surround the fireplace opening using a single piece of SKAMOTEC  
Position cut-out opening in center of panel

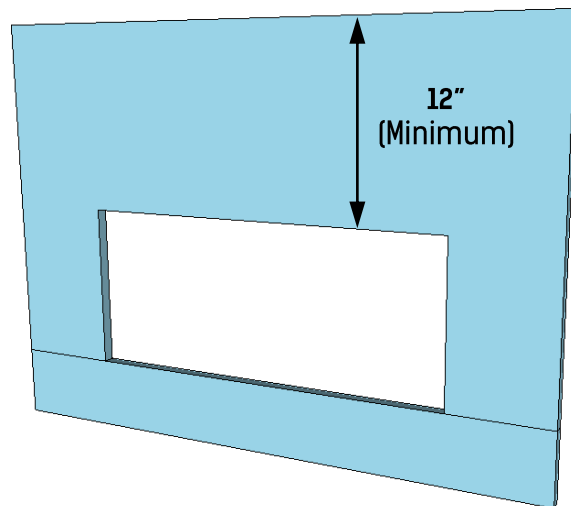

### Option #2

Surround the fireplace opening using two (2) individual pieces of SKAMOTEC  
As shown

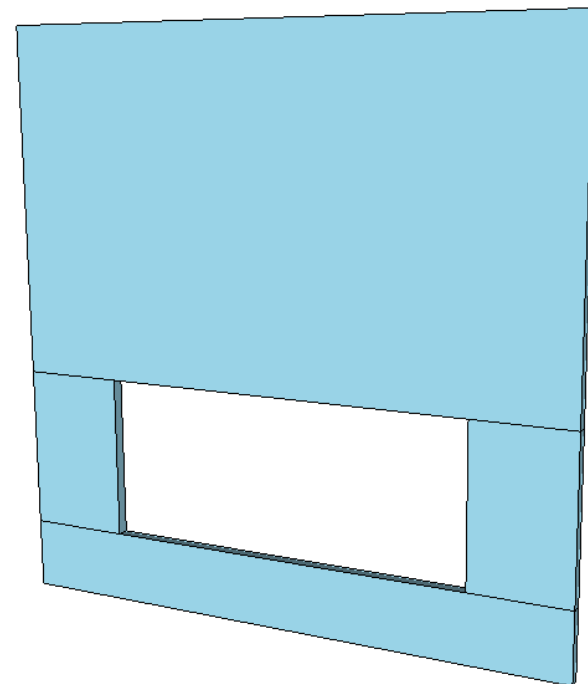

### Option #3

Surround the fireplace opening using four (4) individual pieces of SKAMOTEC  
As shown

### Important

Maintain a minimum of 1/8" clearance around the fireplace frame, to allow for expansion.

**Do not** fasten SKAMOTEC to the fireplace structure

**Remember** when connecting two (2) vertical panels, all joints must be supported with an additional joint plate on the backside

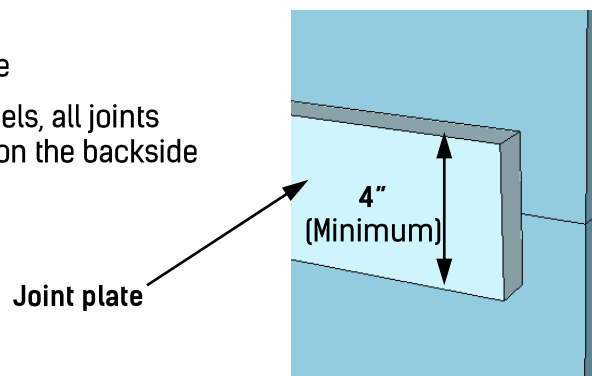

## Wall Support for Stone Wall Application

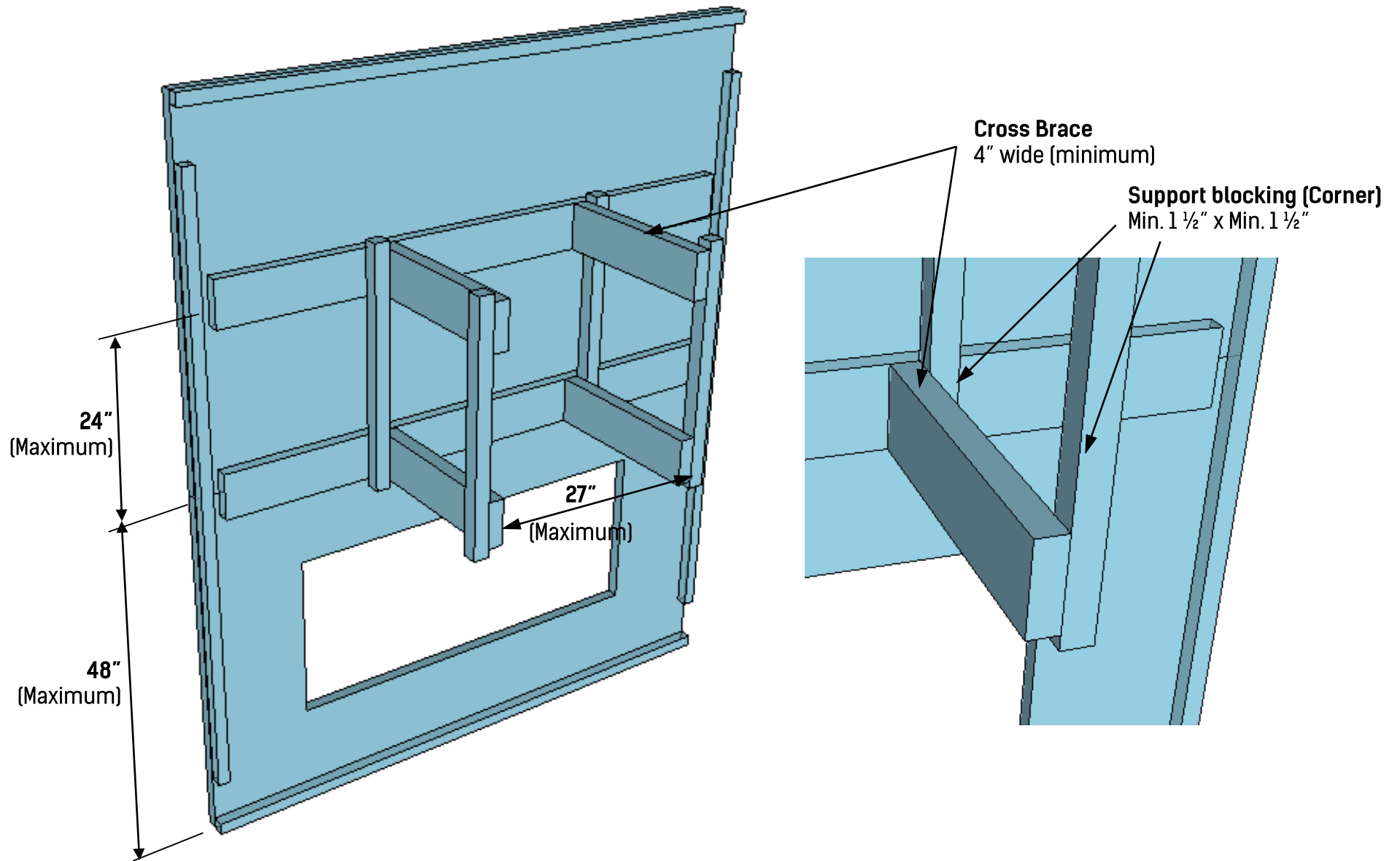

# Mounting TV's and Mantels

## Key Installation Points

- **For TV's:** It is recommended to recess the TV to protect from heat from the front of the fireplace unless stated by the Fireplace Manufacture.
  - It is recommended to use a fixed TV mount
  - Please see Skamotec 225 TV Installation Guide for more details
- **For Mantels:** It is recommended to add additional support. Please see "Wall Support for Stone Application" on page 7.
- Installation for TV and Mantels create a butterfly with a bolt, nut and washer though the back of Skamotec 225 board. See below for details.

Front of Enclosure

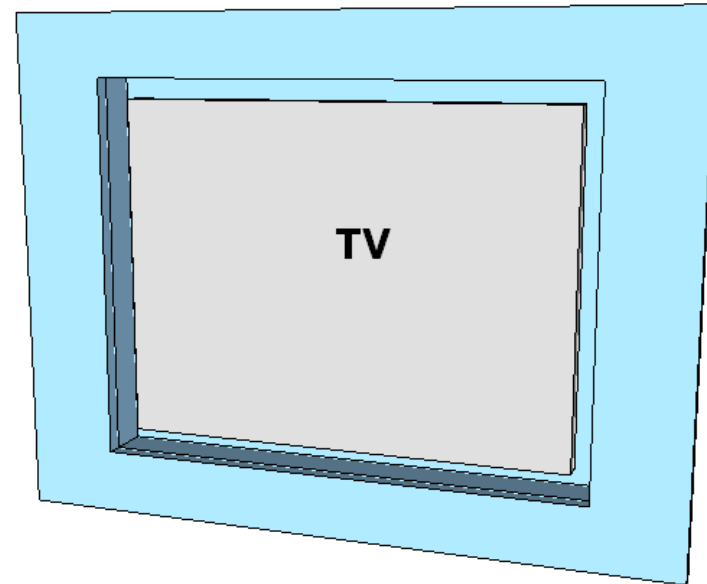

Back of Enclosure

**Surface Mount Steel Stud**  
with #10 x 1" self tapping metal screw  
or equivalent

**Bolt and Washer**  
Recommended: 5/16" dia x 2-1/2" bolt  
5/16" Fender Washer and Nut

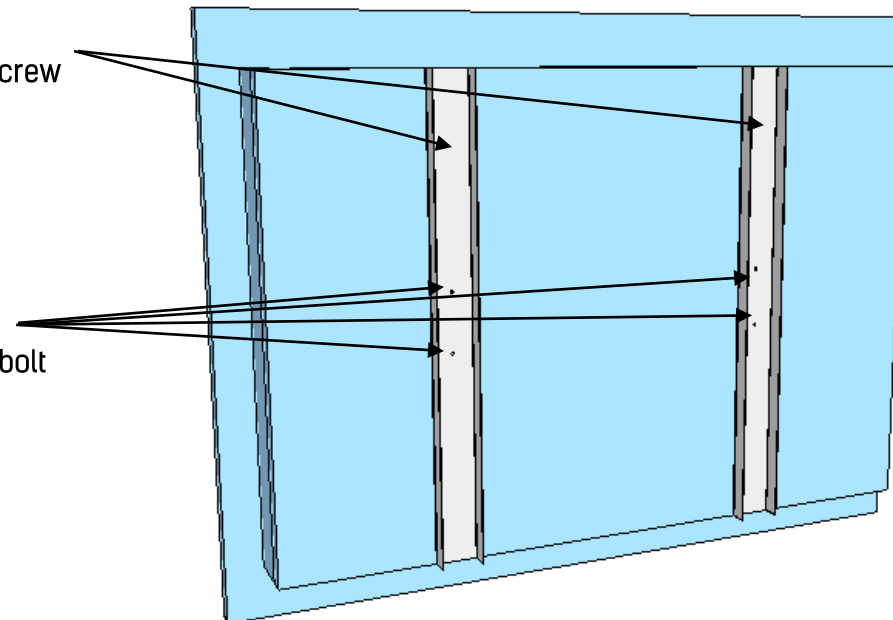



# Finishing – Corners & Joints

## Preparing the Surface for Paint

- **Recommended Drywall Compound for 1<sup>st</sup> coat**
  - **United States:** USG All Purpose Joint Compound (or equivalent)
  - **Canada:** Synko Lite Joint Drywall Taping Compound (or equivalent)
- Prepare the surface by thoroughly moistening the surface with water; apply using a sponge
- Now, applying *Recommended Drywall Compound* to the desired areas, includes all joints
- Then apply your joint tape
  - paper tape – low temperature areas
  - nylon mesh tape – high temperature
- Now, re-apply *Drywall Compound* over the joint tape
- To apply corners beads, apply more *Drywall Compound* to the corners
- Then apply paper or metal Corner beads
- Then re-apply *Drywall Compound* as required

**Note: Corners beads are not recommended around edge of fireplace opening due to high temperatures**

United States



Canada

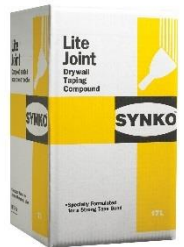

## Paint

- Using a ¼" (5mm) roller apply a thin coat of 100/% acrylic latex primer
- (This will help the paint to properly attach to the material)
- Sand in-between coats
- Then apply a second thin coat of 100/% acrylic latex primer (building up your layers)
- Apply finish coat

**Note: do not use a primer/sealer mix, as this is too thick & will not bond to Skamotec 225**

For Skamotec 225 Installation Video Finishing Application.  
Start video at the following time: 6:42



# Finishing – Materials

## Tile

- Prepare the surface by moisten the surface with water, use a sponge
- 1<sup>st</sup> apply a scratch coat of *All Purpose Thin-Set Mortar* to the area to be tiled
- Using a notch trowel apply a layer of *All Purpose Thin-Set Mortar* with on the backside of the tile
- Install tile

## Stone/Brick Surface

- Skamotec advantage is that no tar paper or metal lath is required
  - Prepare the surface by thoroughly moistening the surface with water; apply using a sponge
  - Now, apply a scratch coat, use *All Purpose Thin-Set Mortar* to the area to be stoned
- Tip:** We recommend using *All Purpose Thin-Set Mortar* rather than mason/mortar mix typically known as “Type S” because it adheres better, and will not dry-out too quickly
- Then, apply your nylon joint mesh tape
  - Then, apply a layer of *All Purpose Thin-Set Mortar* to the backside of the stone
    - Now, install your stone

Recommend **All Purpose Thin-Set Mortar**  
or equivalent

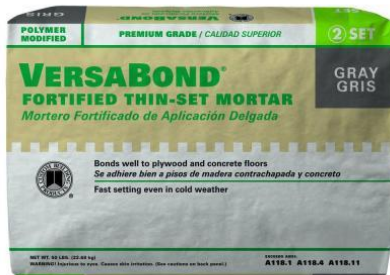

For Skamotec 225 Installation Video Finishing Application.  
Start video at the following time: 6:42



## The SKAMOTEC 225 Advantage

One building product, multiple design solutions

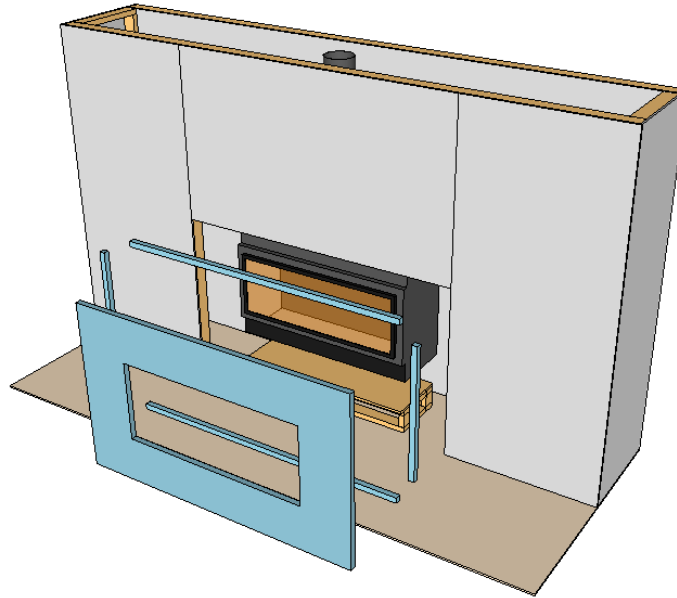

### FRONT FACE - FLAT WALL INSTALLATION

All the material you require to build the Front Face is constructed using **SKAMOTEC 225**

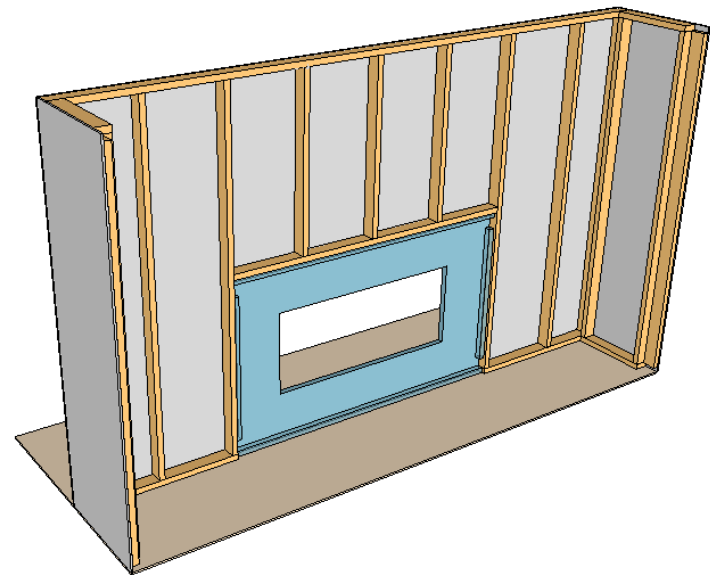
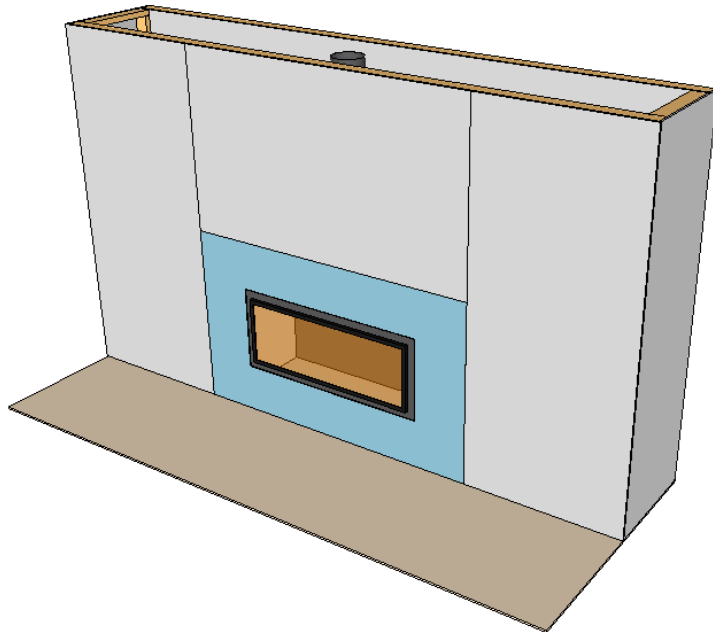

No need for steel or wood framing  
Just one material; **SKAMOTEC 225**

**The SKAMOTEC 225 Advantage**  
One building product, multiple design solutions

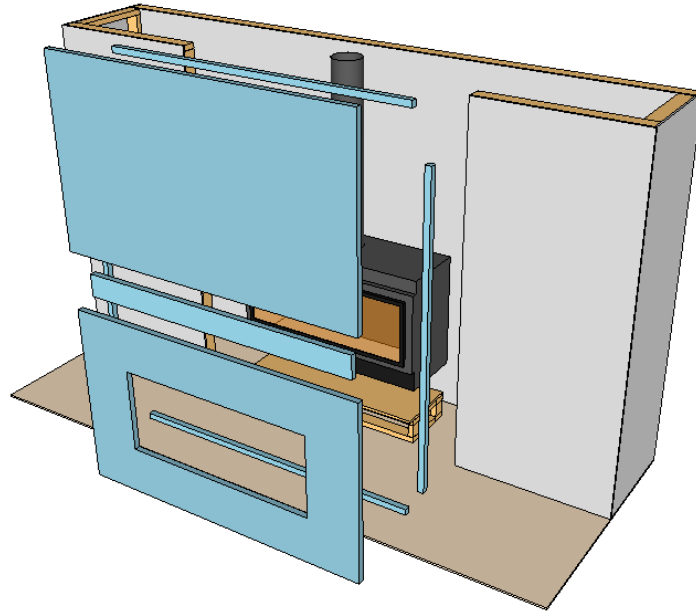

**FRONT FACE - FLAT WALL INSTALLATION**

All the material you require to build the Front Face is constructed using **SKAMOTEC 225**

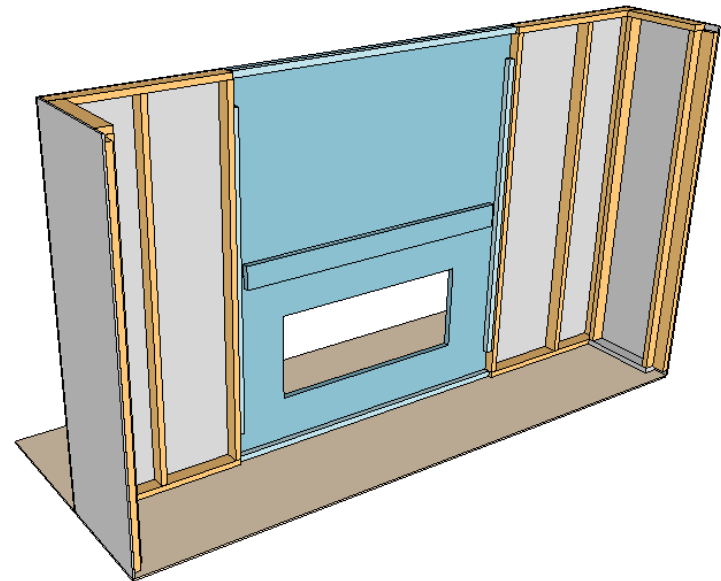
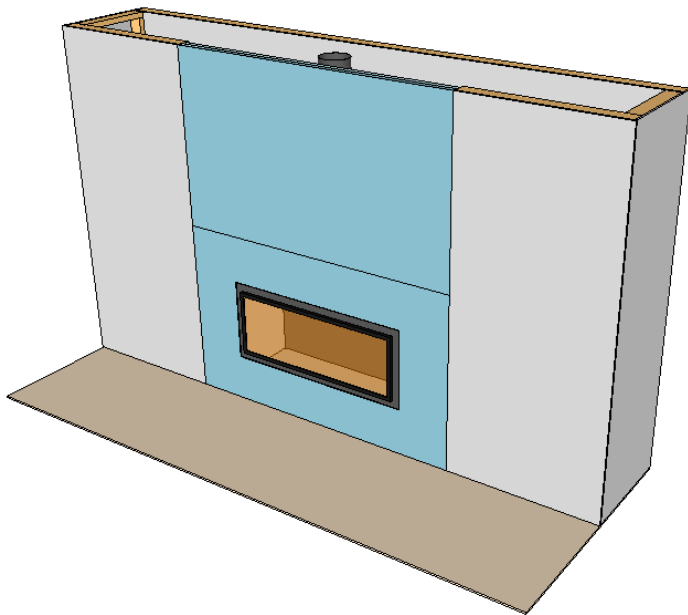

No need for steel or wood framing  
Just one material; **SKAMOTEC 225**

**The SKAMOTEC 225 Advantage**  
One building product, multiple design solutions

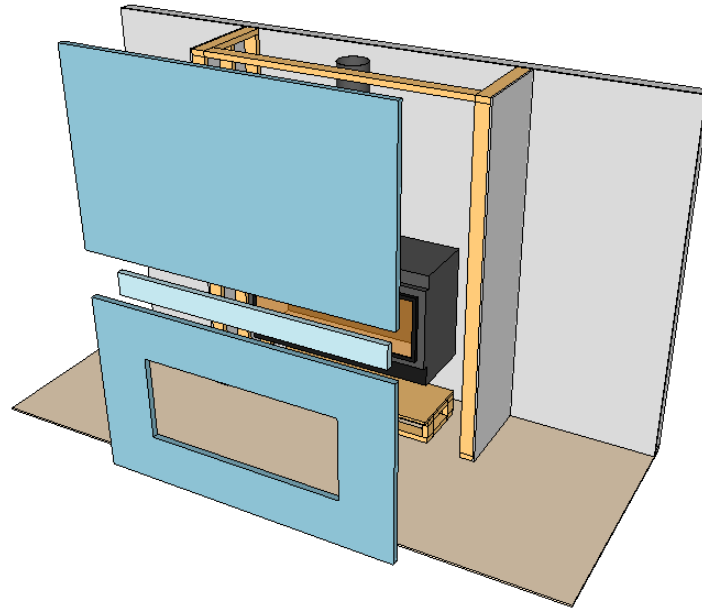

**FRONT FACE - BOX WALL INSTALLATION**

All the material you require to build the Front Face is constructed using **SKAMOTEC 225**

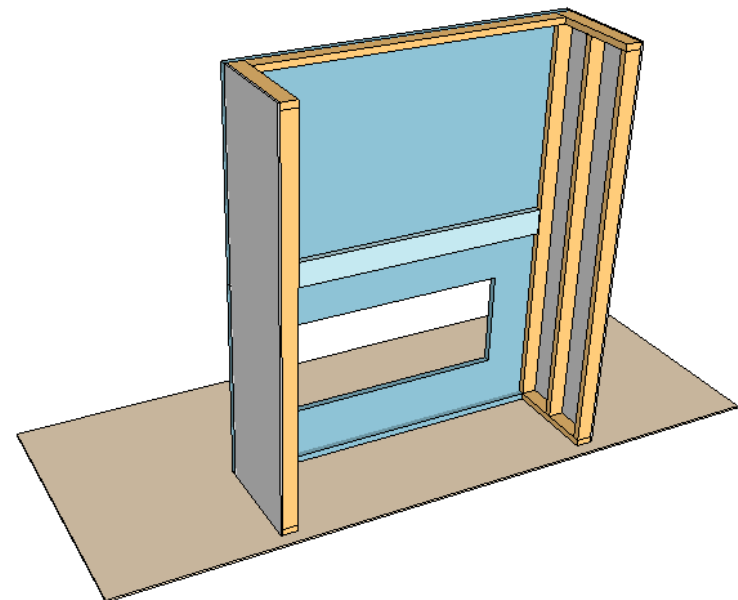
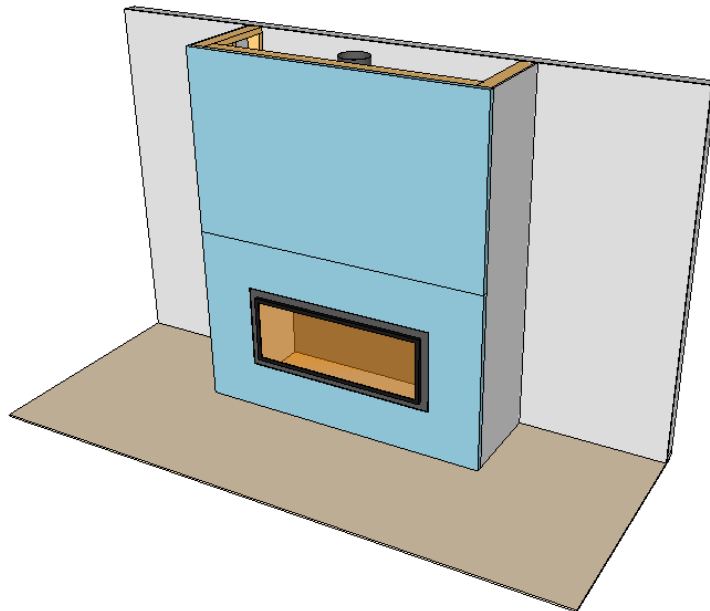

No need for steel or wood framing  
Just one material; **SKAMOTEC 225**

**The SKAMOTEC 225 Advantage**  
One building product, multiple design solutions

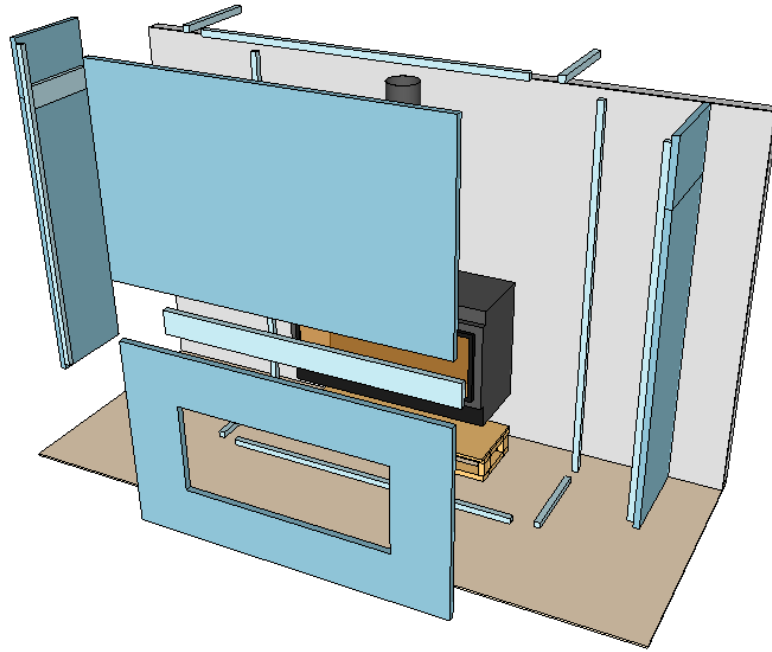

**ALL SKAMOTEC - BOX INSTALLATION**

All the material you require to build the fireplace enclosure is constructed using **SKAMOTEC 225**

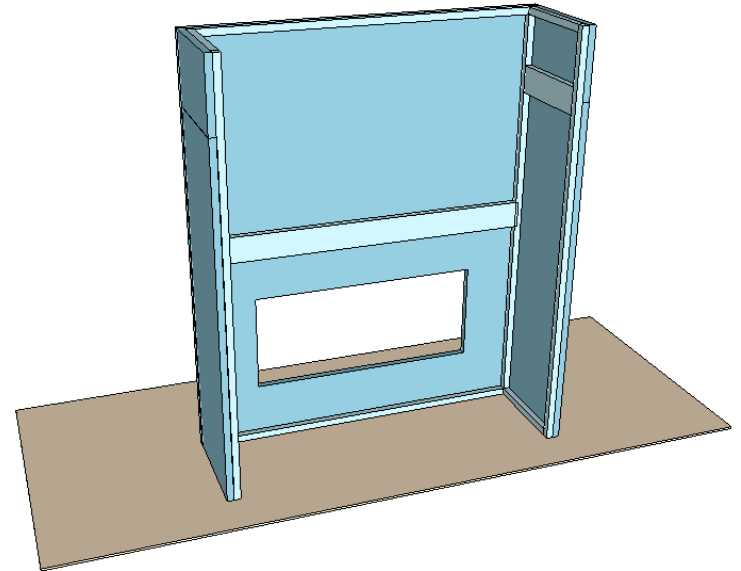
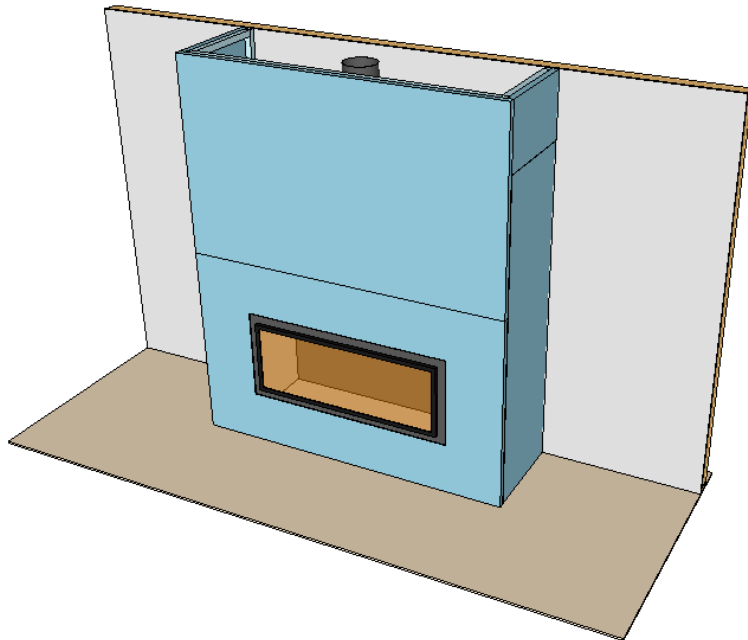

No need for steel or wood framing  
Just one material; **SKAMOTEC225**

**The SKAMOTEC 225 Advantage**  
One building product, multiple design solutions

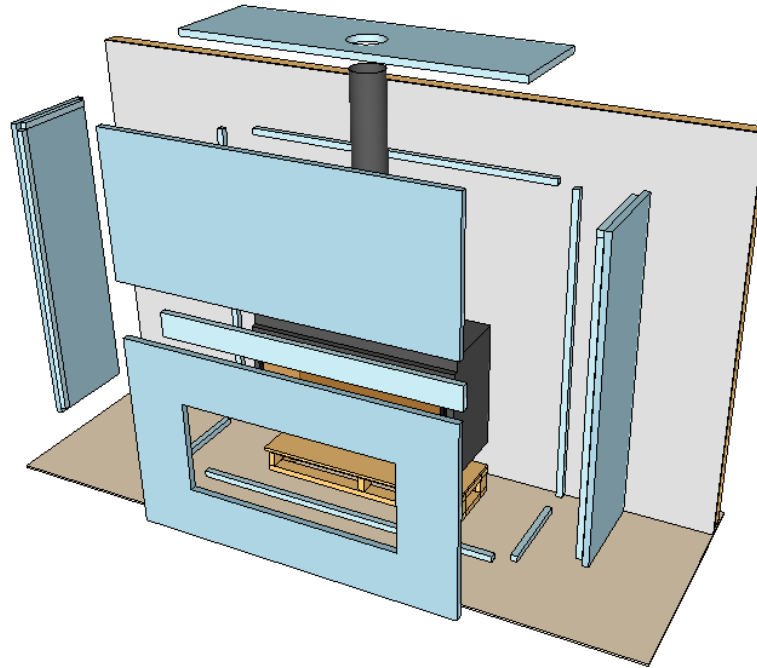

**ALL SKAMOTEC - SMALL BOX INSTALLATION**

All the material you require to build the fireplace enclosure is constructed using **SKAMOTEC 225**

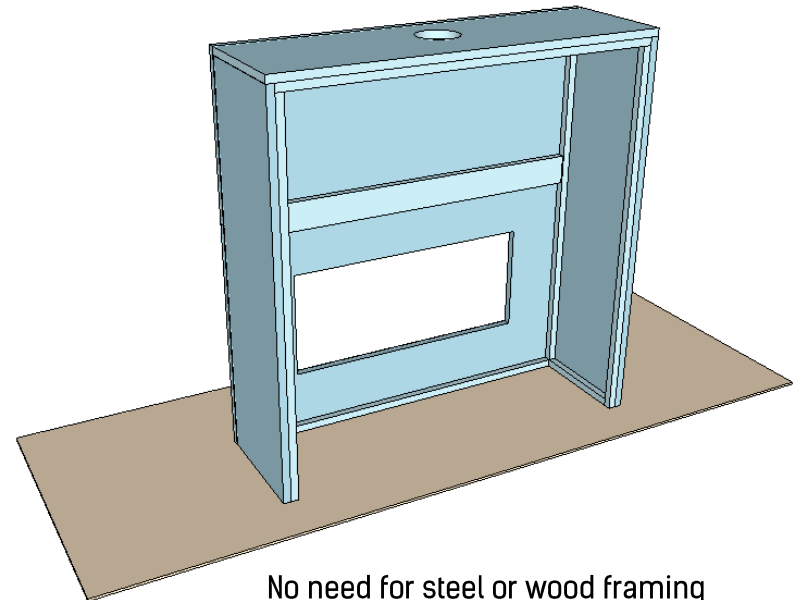
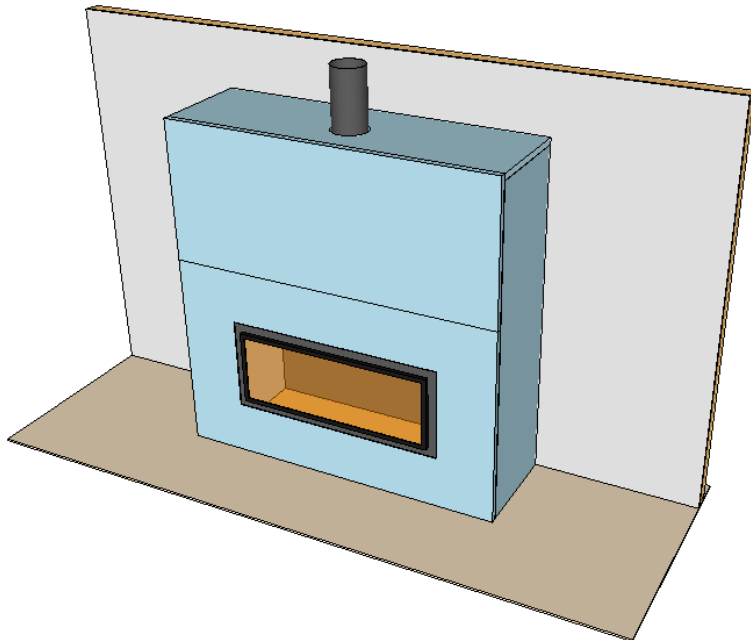

No need for steel or wood framing  
Just one material; **SKAMOTEC 225**