



Q2 FIREPLACE

Installation Reference Guide

REFER TO OWNER'S MANUAL FOR SPECIFIC INSTALLATION REQUIREMENTS AND ADDITIONAL PRODUCT INSTRUCTIONS

Minimum Framing Dimensions

Depth	15 7/8"	403 mm
Width	34 5/8"	879.5 mm
Header Height	40"	1016 mm
Enclosure Ceiling (Top Vent)	*54"	1372 mm
Enclosure Ceiling (Rear Vent)	43 1/2"	1105 mm

*Minimum dimension with only an elbow off the top. Any additional vertical rise added will increase the enclosure height accordingly.

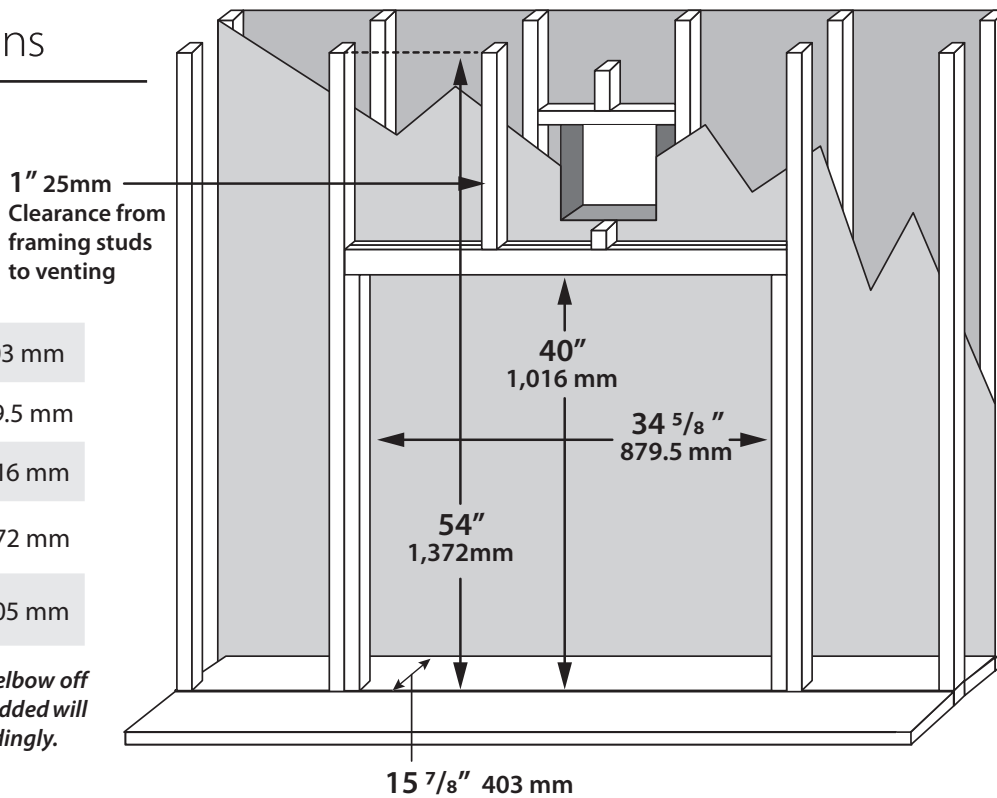

Clearance to Combustibles

A - Side of unit to side wall	4 5/8"	117 mm
B - Minimum clearance to enclosure ceiling (Top Vent)	54"	1372 mm
B - Minimum clearance to enclosure ceiling (Rear Vent)	43 1/2"	1105 mm
C - Minimum clearance to mantel height	See Chart	See Chart
D - Front of door to edge of floor protection	0"	0 mm
E - Minimum alcove width	48"	1220 mm

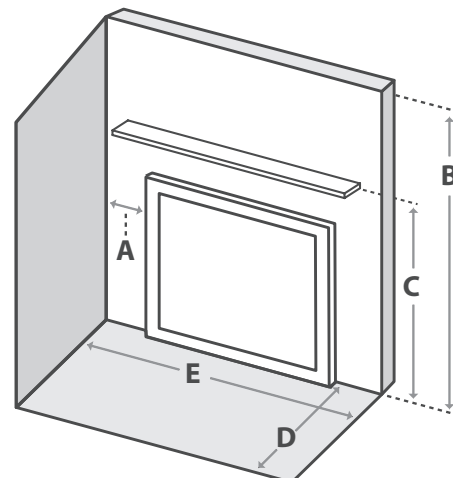

Non-Combustible Board Placement

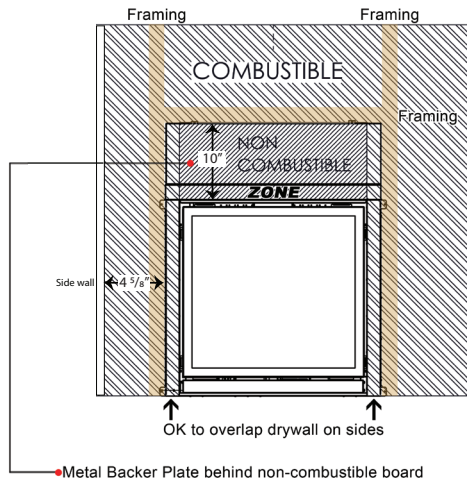

Minimum Venting Requirements

This appliance uses a 4" (101mm) exhaust / 6 5/8" (168mm) air intake vent pipe system. For safe and proper operation of the appliance follow the venting instructions exactly. Deviation from the minimum vertical length can create difficulty in burner start-up and sooting. Allow several minutes for the flame to stabilize after ignition under extreme vent configurations. It is recommended for vent lengths that pass through unheated spaces (garages, attics, crawl spaces) be insulated to minimize condensation. See manual for more info.

***Note: Glass Units can NOT be rear vented.**

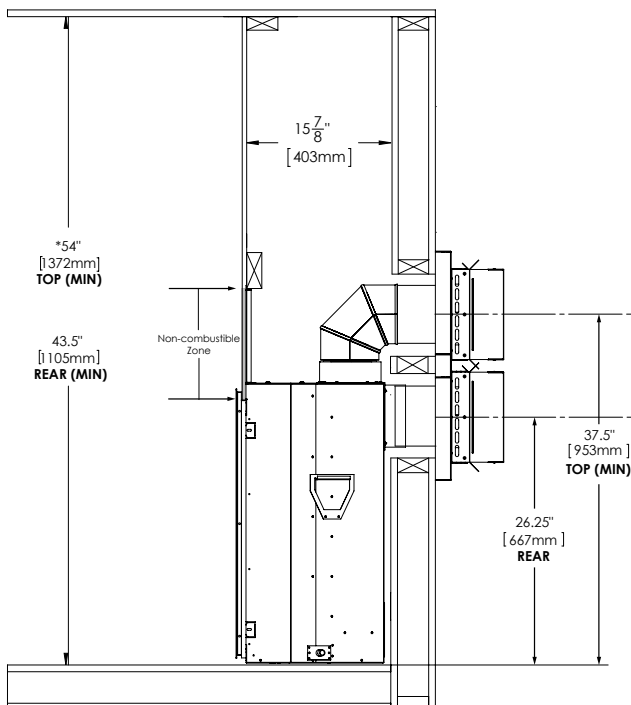

Fireplace Dimensions

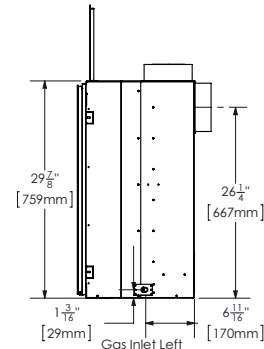
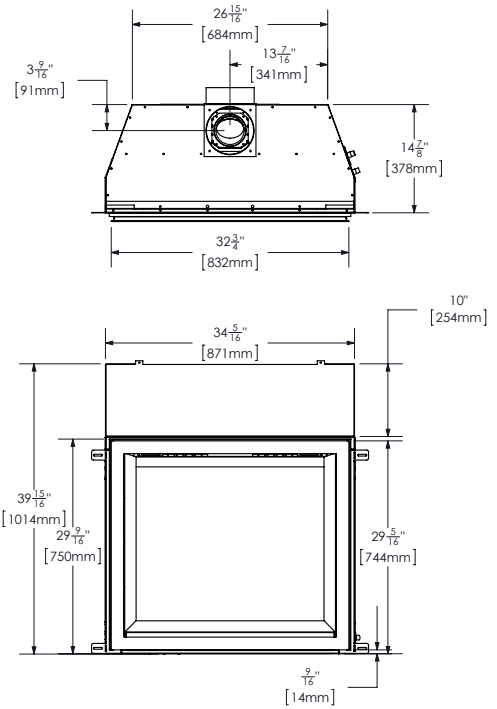

Mantel Projections

Note: Mantle height dimensions are based from the bottom of the appliance.

