

CHASKA 34, CHASKA 335S, CHASKA 29, CHASKA 25

GAS INSERTS



Chaska 29 Log with a Rectangle Black Screen Front, with optional Black Enamel refractory, and a custom 3-sided shroud

QUALITY FIREPLACES FOR LIFE.

KOZY  **HEAT**
FIREPLACES



Chaska 34 Rock shown with a Black Rectangle screen front, a custom 4-sided shroud, and a low mantel kit

CHASKA SERIES

Decorative Safety Screen Fronts

Sizes shown below:

Chaska 34 & 335S / Chaska 29 / Chaska 25



Rectangle Screen Front
with optional Black Enamel refractory
Screen Front available in Black, Brushed Stainless







Rectangle Screen Front
in Brushed Nickel Overlay with the Rock Kit
with Black Enamel refractory
Screen Front available in Antique Copper, Brushed Nickel (Not available for Chaska 25)

Chaska 34, Chaska 29 & Chaska 25 Control



Komfort Kontrol Remote



-  Thermostat function
-  Flame height modulation
-  Fan speed modulation
-  Light kit modulation
-  IPI to continuous pilot

Chaska 29 Millivolt & Chaska 335S Optional Controls



Thermostat Remote or Deluxe On/Off Remote



Wired or Wireless Wall Mount Thermostat



Wireless wall switch



Chaska 29 Glass with a Rectangle Screen Front in Brushed Stainless, Glacier Crystal Glass, optional Beach Accent Kit and a custom 4-sided shroud



Prairie Screen Front
in Black with optional Rustic Brick refractory
Screen Front available in Black, Rust, Titanium

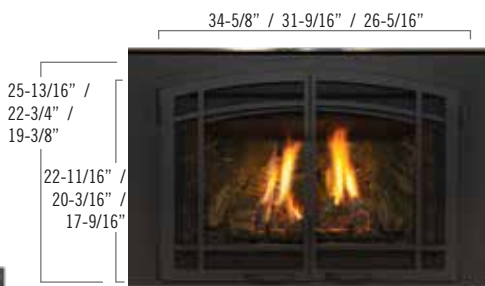

Arched Prairie Full Door Screen Front
with optional Traditional Brick refractory
Screen Front available in Black



Arched Prairie Screen Front
with Beach Accent Kit and optional Black Enamel refractory
Screen Front available in Black, Rust, Titanium



Arched Screen Front
with optional Black Enamel refractory
Screen Front available in Black in all models.
Antique Copper & Brushed Nickel in 34, 335S and 29 only.



Mission Screen Front
in Vintage Bronze with Traditional Brick refractory
Screen Front available in Vintage Bronze, Weathered Charcoal



Chaska 29 Glass shown with Rectangle Screen Front in black with Glacier Crystal glass and a 3-sided shroud

CHASKA SERIES

Media & Refractory Options



Log Set with optional Traditional Brick Refractory
Traditional Brick refractory available in the Chaska 34 Log, Chaska 29 Log, Chaska 335S and the Chaska 25.



Log Set with optional Rustic Brick Refractory
Rustic Brick refractory available in the Chaska 34 Log, Chaska 29 Log, Chaska 335S and the Chaska 25



Crushed Glass with optional Enamel Refractory*
*Enamel Refractory standard in the Chaska 34 Rock & Glass, and Chaska 29 Rock & Glass. *Unavailable in the millivolt versions and the Chaska 25.*



Driftwood/Rock
(Optional Accent Media with Glass)



Beach Accent Kit
(Optional Accent Media with Glass)



Chaska 29 Rock shown with an Arched Mission Screen Front in Vintage Bronze

Glass Media

Crushed Glass



Reflective Midnight Crushed Glass



Reflective Copper Crushed Glass

Crystals



Glacier



Amber



Black



Seabreeze

Burn Videos



Chaska 34 Rock



Chaska 34 Crushed Glass with a Beach Accent Kit



Chaska 34 Log



Chaska 29 Rock



Chaska 29 Log



Chaska 335S



Chaska 25

CHASKA SERIES

The Chaska 34 (CSK 34-L, CSK 34-G & CSK 34-R), Chaska 29 (CSK 29-L, CSK 29-G & CSK 29-R) and Chaska 25 come standard with an Electronic Ignition Pilot System. The included Komfort Kontrol remote will adjust the flame and fan speed. The Chaska 335S model comes standard with a millivolt operating system and fan kit. The Chaska 29 model offers an optional millivolt operating system and fan kit.

Specifications

Model	Chaska 34 IPI	Chaska 335S	Chaska 29 Log & Rock	Chaska 29 Glass	Chaska 29 MV	Chaska 25
Height	23"	23"	19-1/4"	19-1/4"	19-1/4"	17-1/2"
Width	33-3/8"	33-3/8"	29"	29"	29"	25-3/8"
Back Width	24-3/8"	24-3/8"	18-7/8"	18-7/8"	18-7/8"	20-3/8"
Depth	16"	16"	14-1/2"	14-1/2"	14-1/2"	15"
Weight	150 lbs.	150 lbs.	140 lbs	140 lbs	140 lbs	140 lbs
Viewing Area	30-1/8" X 17-13/16"	29-5/8" X 15-13/16"	26-1/8" X 12-7/8"	26-1/8" X 12-7/8"	26-1/8" X 12-7/8"	22-1/8" X 12-5/16"
BTU NG High / Low	34,000 / 18,500	36,000 / 22,000	30,500 / 16,000	25,500 / 14,000	28,500 / 18,500	26,000 / 13,500
BTU LP High / Low	34,000 / 18,500	36,500 / 22,000	30,000 / 16,000	25,500 / 13,500	29,000 / 22,000	25,500 / 13,000
ENERGUIDE P.4 NG / LP	73.22% / 76.49%	65.74% / 66.63%	72.27% / 72.36%	60.8% / 63.21%	71.26% / 71.33%	71.44% / 72.08%
Steady State NG / LP	77% / 79%	80% / 75%	74% / 74%	72.21% / 72.26%	74% / 74%	77.58% / 78.17%
AFUE % NG / LP	75% / 77%	73.8% / 76.2%	71% / 72.12%	66.62% / 66.09%	71% / 72.12%	69.79% / 70.33%
Valve System	IPI - Standard on all Versions	Millivolt	IPI - Standard on all Versions	IPI - Standard on all Versions	Millivolt	IPI
Standard Black Enamel Refractory	(CSK 34-R) Back curved black panel (CSK 34-G) Optional (CSK 34-L)	N/A	(CSK 29-R) Optional (CSK 29-L)	Standard	N/A	N/A
Ember Light Kit	Standard (CSK 34-L, CSK 34-R)	N/A	Standard	N/A	N/A	N/A
Accent Light Kit	Standard (CSK 34-G)	N/A	N/A	Standard	N/A	N/A
Glass Media	Required (CSK 34-G)	N/A	N/A	Required	N/A	N/A
Ceramic Glass	Standard	Standard	Standard	Standard	Standard	Standard
Fan Kit Availability	Standard for All Versions	Standard	Standard for All Versions	Standard	Standard	Standard
Screen Front	Required	Required	Required	Required	Required	Required

Features, Options & Specifications are subject to change.

Clearances

Model	Chaska 34	Chaska 335S	Chaska 29 Log & Rock	Chaska 29 Glass	Chaska 29 MV	Chaska 25
From insert to combustible floor in front	Refer to chart in manual	Refer to chart in manual	Refer to chart in manual	Refer to chart in manual	Refer to chart in manual	Refer to chart in manual
From insert to side wall	6"	12"	6"	6"	6"	3"
Mantel 9" deep from top of insert*	16"	16"	16"	16"	16"	9"
Mantel 9" deep from top of insert with Low Mantel Kit*	11"	11"	11"	11"	11"	N/A

*Low Mantel Kit can attach to any Rectangle Screen Front or (square) Prairie Screen Front to reduce mantel clearances by up to 5"

Refer to the installation manuals for complete installation & venting requirements. See additional mantel clearance configurations in the installation manual.

Note: Over time, antique copper will react with oxygen, heat, and other aspects of the environment and naturally change color, or patina.

Each unit factory tested

Certified to ANSI Z21.88 Vented Gas Heaters

Venting

A gas insert will help in eliminating the heat loss and cold down drafts that you have likely experienced from your existing fireplace and chimney. As the first company to introduce direct-vent technology to gas inserts, Kozy Heat inserts and fireplaces use 100% outside air for combustion. Our inserts and dual 3" aluminum flex venting structure create a sealed system and eliminates the potential of bringing smoke or fumes into the home. When compared to gas logs or "ventless" inserts, this is the safest and most efficient choice that you can make for your family.

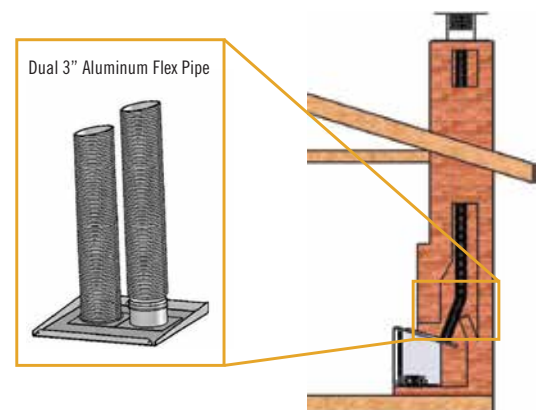

Chaska 34

LEFT SIDE

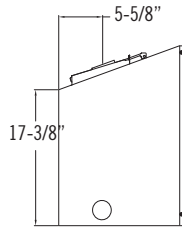

FRONT

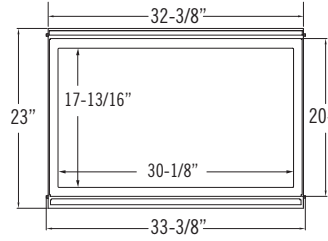

RIGHT SIDE

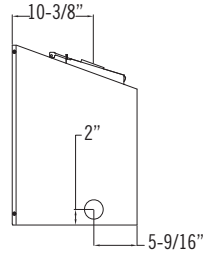

TOP

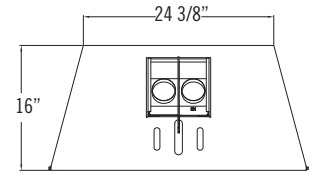

Chaska 335S

LEFT SIDE

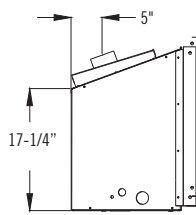

FRONT

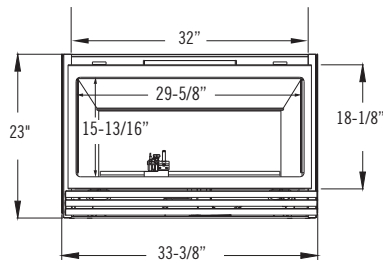

RIGHT SIDE

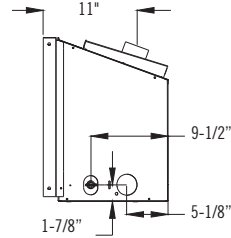

TOP

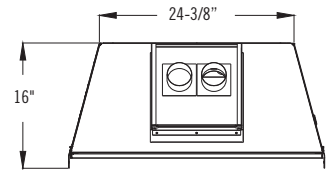

Chaska 29

LEFT SIDE

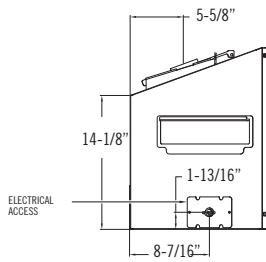

FRONT

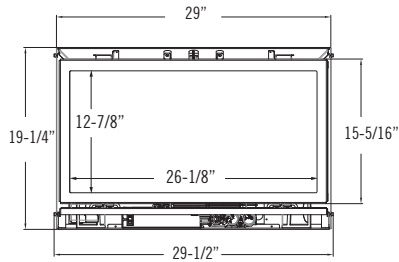

RIGHT SIDE

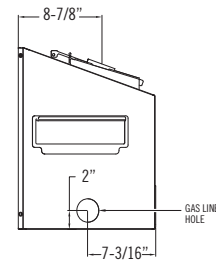

TOP

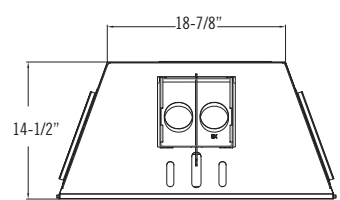

Chaska 25

LEFT SIDE

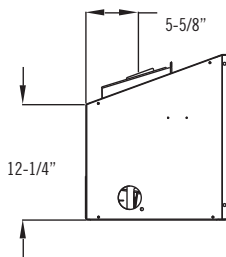

FRONT

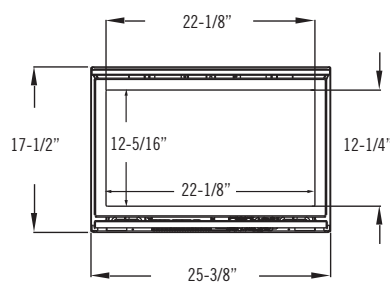

RIGHT SIDE

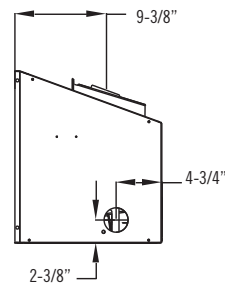

TOP

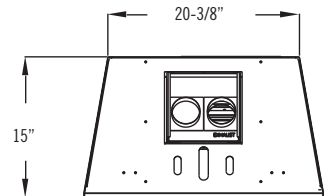



Chaska 335S shown with an Arched Prairie Full Door Screen Front and a Traditional Brick refractory

Fireplace brochures are for advertising purposes only. Refer to the specific fireplace manual for installation.

CHASKA SERIES

Existing Fireplace Requirements

Chaska 34 & 335S

Existing Fireplace Opening must be at least:

- Height: 23-1/2"
- Width: 33-1/2"
- Back Width: 24-1/2"
- Depth: 16-3/8" (CSK-34)
- Depth: 16-1/2" (CSK-335S)

Existing Chimney:

Inside Diameter:

- Factory built solid fuel chimney: 7" min.
- Masonry chimney: 6" x 8" min.
- Minimum chimney height: 12'
- Maximum chimney height: 50'

Chaska 29

Existing Fireplace Opening must be at least:

- Height: 19-1/4"
- Width: 29-1/2"
- Back Width: 18-7/8"
- Depth: 15"

Existing Chimney:

Inside Diameter:

- Factory built solid fuel chimney: 7" min.
- Masonry chimney: 6" x 8" min.
- Minimum chimney height: 10'
- Maximum chimney height: 50'

Chaska 25

Existing Fireplace Opening must be at least:

- Height: 17-5/8"
- Front Width: 25-7/8"
- Back Width: 20-5/8"
- Depth: 15-1/4"

Existing Chimney:

Inside Diameter:

- Class 'A' metal: 7" I.D.
- Masonry Chimney: 6" x 8" I.D.
- Minimum chimney height: 10'
- Maximum chimney height: 35'

Vertical Termination ONLY

(Chaska 34, Chaska 335s & Chaska 29)

Minimum vent run: 10'
Maximum vent run: 50'

Vertical Termination ONLY (Chaska 25)

Minimum vent run: 10'
Maximum vent run 35'

Vent System Approval & Requirements

These models are approved for use with the following Vent Systems rigid and flexible pipe:–

- Kozy Heat™ - #816 venting
- Simpson Dura-Vent™
- Selkirk Metalbestos™
- Ameri-Vent™
- ICC™

Shroud Dimensions

*Shroud is Required for Installation

Chaska 34 & 335S

- 27" x 40"
 - 30" x 44"
 - 33" x 46"
 - 34" x 44" Arched
- *Custom sizes available where applicable

Chaska 29

- 25" x 38"
 - 27-1/2" x 42"
 - 30" x 44"
 - 28" x 38 Arched
- *Custom sizes available where applicable

Chaska 25

- 22-1/2" x 36"
 - 25" x 38"
 - 30" x 44"
- *Custom sizes available where applicable

In order to continually provide the highest quality product available, features/options, specifications & dimensions are subject to change. Refer to the unit installation manual for complete installation instructions. Installation must conform with local building codes. **In some regions it may be possible that this appliance qualifies for an energy rebate. See your local dealer for details regarding promotions and qualifications.**

Manufactured by Husson Mfg. Co., Inc.
204 Industrial Park Drive, Lakefield, MN 56150
Phone 1-800-253-4904 www.kozyheat.com



Product Line:



For complete information on the Kozy Heat product line, please contact us at:

FOR CALIFORNIA RESIDENTS ONLY

⚠ California Proposition 65 Warning

WARNING: This product can expose you to chemicals including Carbon Monoxide, that is an externally vented by-product of fuel combustion, which is [are] known to the State of California to cause birth defects or other reproductive harm. For more information, visit www.P65Warnings.ca.gov.