



# **ZERO-CLEARANCE FIREPLACES**

## **WOOD BURNING FIREPLACES**

FOR HEATING SMALL TO LARGE SPACES



FP16 CONTEMPORARY | TRADITIONAL

FP25 CONTEMPORARY | TRADITIONAL

FP30 CONTEMPORARY | TRADITIONAL



FP16

CONTEMPORARY | TRADITIONAL

FOR SMALL TO MEDIUM ROOMS



FP16 CONTEMPORARY - SURROUND TRIM, METALLIC BLACK



FP16 TRADITIONAL ARCH - SURROUND TRIM, METALLIC BLACK

Heat Output Cord Wood

70,000 BTU

35,000 BTU EPA Test Fuel

|                  |              |
|------------------|--------------|
| Efficiency (LHV) | 70.2%        |
| Emissions        | 3.09 gm/hr.  |
| Log Size (max)   | 16–18 inches |
| Firebox Size     | 1.6 cu.ft.   |
| Glass Size       | 173 sq.in.   |
| Weight           | 480 lb.      |

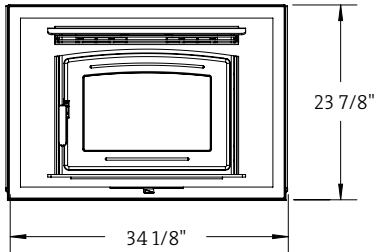

Built for a lifetime of clean woodburning heat, the FP16s are the perfect heating solution for small to medium spaces. Highly efficient and EPA Certified, the FP16 zero clearance woodburning fireplaces feature Pacific Energy’s renowned heavy gauge steel floating firebox, high capacity baffle system, EBT2 for extended burn times, and clean airwash technology to ensure comfort and enjoyment all throughout the season.

FP25

CONTEMPORARY | TRADITIONAL

FOR MEDIUM ROOMS



FP25 CONTEMPORARY - SURROUND TRIM, METALLIC BLACK



FP25 TRADITIONAL ARCH - SURROUND TRIM, METALLIC BLACK

Heat Output Cord Wood

85,000 BTU

33,000 BTU EPA Test Fuel

|                  |             |
|------------------|-------------|
| Efficiency (LHV) | 72.6%       |
| Emissions        | 3.47 gm/hr. |
| Log Size (max)   | 18 inches   |
| Firebox Size     | 2.5 cu.ft.  |
| Glass Size       | 184 sq.in.  |
| Weight           | 610 lb.     |

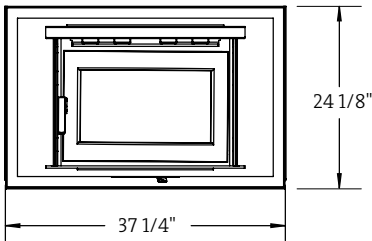

Heat medium spaces with the reduced footprint of a wall-mount fireplace. The FP25’s offer extraordinary wood heat with a Contemporary look or a Traditional Arch and all the Pacific Energy extras. Crafted with a floating firebox of heavy gauge steel, a high capacity baffle system, and EBT2 extended heat technology, these full-featured zero clearance fireplaces are designed for a lifetime of efficient, effective heating.

FP30

CONTEMPORARY | TRADITIONAL

FOR MEDIUM TO LARGE ROOMS



FP30 CONTEMPORARY



FP30 TRADITIONAL ARCH

Heat Output Cord Wood

99,000 BTU

38,500 BTU EPA Test Fuel

|                  |              |
|------------------|--------------|
| Efficiency (LHV) | 76.8%        |
| Emissions        | 2.47 gm/hr.  |
| Log Size (max)   | 18–20 inches |
| Firebox Size     | 3.0 cu.ft.   |
| Glass Size       | 246 sq.in.   |
| Weight           | 626 lb.      |

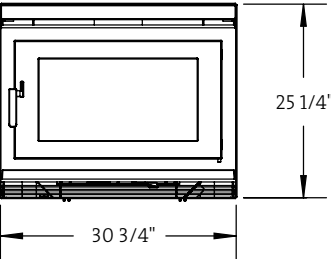

For maximum heating performance, the FP30’s are built around Pacific Energy’s largest, easy loading firebox. Enjoy uncompromised features; floating firebox of heavy gauge steel, high capacity baffle system, extended burn technology (EBT2) and unmatched Airwash technology to keeps the large window of glass clean over extended burn periods. The FP30’s meet the need for high-capacity wood heat, with the space savings and convenience of a wall-mounted fireplace.

STANDARD FEATURES

- Reliable, durable non-catalytic technology
- Air wash system for super clean ceramic glass
- Boost air for easy lighting
- Oversize glass viewing window
- Floating firebox for extended stove life
- 304 Stainless Steel baffle, insulation cover, rails and flame shield
- High-tech multi-port combustion air injection system
- Extended Burn Technology (EBT2)
- Integrated heat exchanger
- East-West loading
- 2x40 cfm temperature actuated blowers
- Single-Lever Air Control
- Cast iron door
- Inside and outside combustion air capable
- Mobile Home Approved
- EPA Certified

Surround trim available in two colours



STANDARD FEATURES

- Reliable, durable non-catalytic technology
- Air wash system for super clean ceramic glass
- Boost air for easy lighting
- Oversize glass viewing window
- Floating firebox for extended stove life
- 304 Stainless Steel baffle, insulation cover, rails and flame shield
- High-tech multi-port combustion air injection system
- Extended Burn Technology (EBT2)
- Integrated heat exchanger
- East-West loading
- 2x80 cfm temperature actuated blowers
- Single-Lever Air Control
- Cast iron door
- Inside and outside combustion air capable
- Mobile Home Approved
- EPA Certified

Surround trim available in two colours



PERFORMANCE OPTIONS

- Powered Heat Distribution System

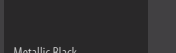

STANDARD FEATURES

- Reliable, durable non-catalytic technology
- Air wash system for super clean ceramic glass
- Boost air for easy lighting
- Oversize glass viewing window
- Floating firebox for extended stove life
- 304 Stainless Steel baffle, insulation cover, rails and flame shield
- High-tech multi-port combustion air injection system
- Extended Burn Technology (EBT2)
- Integrated heat exchanger
- North-South loading
- 2x80 cfm temperature actuated blowers
- Single-Lever Air Control
- Cast iron door
- Cast iron ash lip (Contemporary)
- Inside and outside combustion air capable
- Mobile Home Approved
- EPA Certified

PERFORMANCE OPTIONS

- Powered Heat Distribution System



TECHNOLOGIES

For over 35 years, our mission has been to design and develop cleaner, more efficient, beautiful heating solutions. Our advanced technologies set us apart with engineering excellence and performance, and define what makes Pacific Energy the right choice for your home.

HEAT DISTRIBUTION

Enjoy heat throughout your home with Pacific Energy’s EPA approved Heat Distribution System.

With the FP25 and the FP30, homeowners can supplement their heat source with an optional Heat Distribution System. Using standard “B”

vent piping, the powered heat distribution system transfers heat into isolated rooms. Each heat duct is independently switch controlled, allowing for on demand control and comfort.

For FP25 and FP30 Zero Clearance Fireplaces Only

FLOATING FIREBOX

Our floating firebox system is legendary in the industry. Solidly designed with steel brick-support rails, it allows key parts to freely expand and contract, which reduces metal fatigue and adds years of life to the entire fireplace. The stainless steel baffle (part of the clean-burning secondary combustion system) and the flame shield (which protects the stove top from intense heat) are all part of the floating firebox system.

AIR WASH

Pacific Energy developed the first effective airwash manifold system, a design that flows pre-heated air to the glass surface to keep it clean. A refined design now creates a high-pressure zone in the center and forces air to flow from above and across the glass. Even at low air settings, we are confident that our airwash system is the most effective available. And thats why our glass doors are among the cleanest in the industry.

EBT2 EXTENDED BURN

Our second-generation Extended Burn Technology, or EBT2, precisely regulates secondary airflow based on vacuum created by the chimney for a longer, cleaner, more economical burn. This automatically adjusts the secondary combustion system, for a cleaner, more efficient burn and extended burn time.

| PERFORMANCE EFFICIENCY | BURN TIME      |              |         |
|------------------------|----------------|--------------|---------|
|                        | Combustion Air | Fuel Quality | Draft   |
|                        |                |              | no EBT2 |
|                        |                |              | EBT2    |

POWERED HEAT DISTRIBUTION SYSTEM

Above or below grade  
5 to 20 feet

UNIT DIMENSIONS

FP16

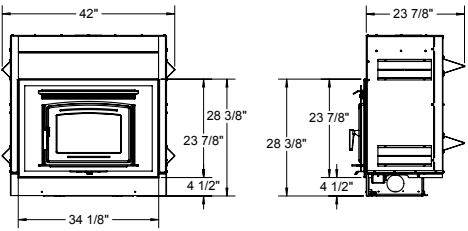

FP25

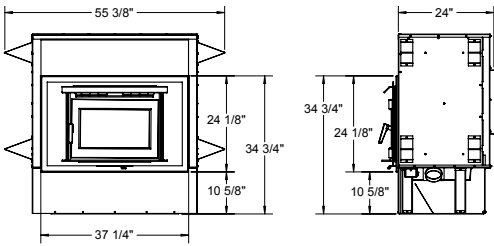

FP30

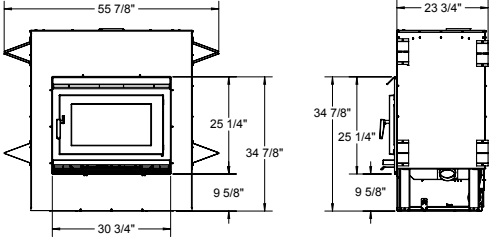

MINIMUM FRAMING DIMENSIONS

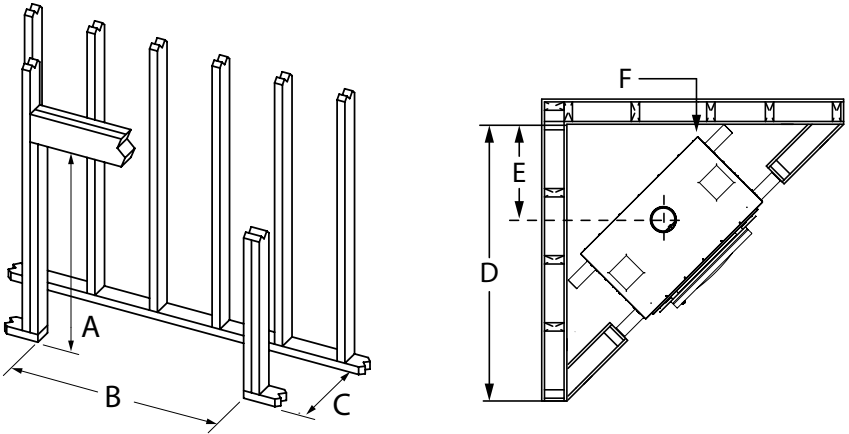

TECHNOLOGIES

- AIR WASH
- BAFFLE SYSTEM
- EBT2 EXTENDED BURN
- FLOATING FIREBOX
- HEAT DISTRIBUTION
- KNIFE EDGE DOOR
- SINGLE LEVER

|                  | FP16    | FP16 Arch | FP25    | FP25 Arch | FP30    | FP30 Arch |
|------------------|---------|-----------|---------|-----------|---------|-----------|
| A                | 55 1/2" | 55 1/2"   | 62"     | 62"       | 63 1/2" | 63 1/2"   |
| B <sup>1</sup>   | 42"     | 42"       | 56"     | 56"       | 56"     | 56"       |
| C <sup>1,2</sup> | 24"     | 24"       | 24"     | 24"       | 24"     | 24"       |
| D                | 57 3/8" | 57 3/8"   | 68 3/8" | 68 3/8"   | 73 1/2" | 73 1/2"   |
| E                | 21 1/2" | 21 1/2"   | 23 7/8" | 23 7/8"   | 25 1/4" | 25 1/4"   |
| F                | 2"      | 2"        | 3 1/8"  | 3 1/8"    | 5 1/2"  | 5 1/2"    |

1) Not including chase lining if used 2) Not including facing materials

MANTLE CLEARANCE

| Mantle Depth | Height from Base of Unit |           |         |           |         |           |
|--------------|--------------------------|-----------|---------|-----------|---------|-----------|
|              | FP16                     | FP16 Arch | FP25    | FP25 Arch | FP30    | FP30 Arch |
| 4"           | 46 1/2"                  | 46 1/2"   | 50 3/4" | 50 3/4"   | 51"     | 51"       |
| 5"           | 47"                      | 47"       | 50 3/4" | 50 3/4"   | 51 1/2" | 51 1/2"   |
| 6"           | 47 1/2"                  | 47 1/2"   | 50 3/4" | 50 3/4"   | 52"     | 52"       |
| 7"           | 48"                      | 48"       | 50 3/4" | 50 3/4"   | 52 1/2" | 52 1/2"   |
| 8"           | 48 1/2"                  | 48 1/2"   | 50 3/4" | 50 3/4"   | 53"     | 53"       |
| 9"           | 49"                      | 49"       | 50 3/4" | 50 3/4"   | 53 1/2" | 53 1/2"   |
| 10"          | 49 1/2"                  | 49 1/2"   | 50 3/4" | 50 3/4"   | 54"     | 54"       |
| 11"          | 50"                      | 50"       | 50 3/4" | 50 3/4"   | 54 1/2" | 54 1/2"   |
| 12"          | 50 1/2"                  | 50 1/2"   | 50 3/4" | 50 3/4"   | 55"     | 55"       |

For reference only. Installations should be based on manuals and rating labels. Specifications subject to change.

BAFFLE SYSTEM

Pacific Energy is a recognized industry leader in “clean burn” technology, as exemplified in our unique high capacity baffle system for preheating secondary combustion air for re-burning. By burning the combustible elements in the air, we improve our stoves environmental performance while significantly reducing the amount of wood that is consumed.



pacificenergy.net